

**RESIDENTIAL LAND AVAILABILITY  
PARISH: GREAT SALING**

**DWELLING SITES AS AT: 31.3.10**

Map site ref. no.	Location of site	Planning application reference where relevant	Estimated dwelling sites without planning permission	Dwelling sites with planning permission				Total all dwelling sites with planning permission	Sum total all dwelling sites with or without planning permission	According to PDL definition as at April 2010: Dwelling plots on		According to revised PDL definition as at June 2010: Dwelling plots on	
				Total site capacity (including built)	Dwellings not started	Dwellings under construction	With outline plg.perm.			With full plg.perm.	Previously developed land	Greenfield	Previously developed land
23	The Glebe The Street	1680/05		1		1		1	1	1	0	1	0
24	Part grounds The Vicarage The Street	1428/06		1			1	1	1	1	0	0	1
25	The Coach House Saling Grove	1223/09		12		12		12	12	12	0	12	0
<b>Gross total</b>			<b>0</b>	<b>0</b>	<b>13</b>	<b>1</b>	<b>14</b>	<b>14</b>	<b>14</b>	<b>14</b>	<b>0</b>	<b>13</b>	<b>1</b>
<i>Losses:</i>													
23	<i>The Glebe The Street</i>	<i>1680/05</i>		<i>1</i>	<i>-1</i>			<i>-1</i>	<i>-1</i>	<i>-1</i>	<i>0</i>	<i>-1</i>	<i>0</i>
25	<i>The Coach House Saling Grove</i>	<i>1223/09</i>		<i>12</i>	<i>-12</i>			<i>-12</i>	<i>-12</i>	<i>-12</i>	<i>0</i>	<i>-12</i>	<i>0</i>
<i>Total losses:</i>			<i>0</i>	<i>0</i>	<i>-13</i>	<i>0</i>	<i>-13</i>	<i>-13</i>	<i>-13</i>	<i>-13</i>	<i>0</i>	<i>-13</i>	<i>0</i>
<b>Net total:</b>			<b>0</b>	<b>0</b>	<b>0</b>	<b>1</b>	<b>1</b>	<b>1</b>	<b>1</b>	<b>1</b>	<b>0</b>	<b>0</b>	<b>1</b>

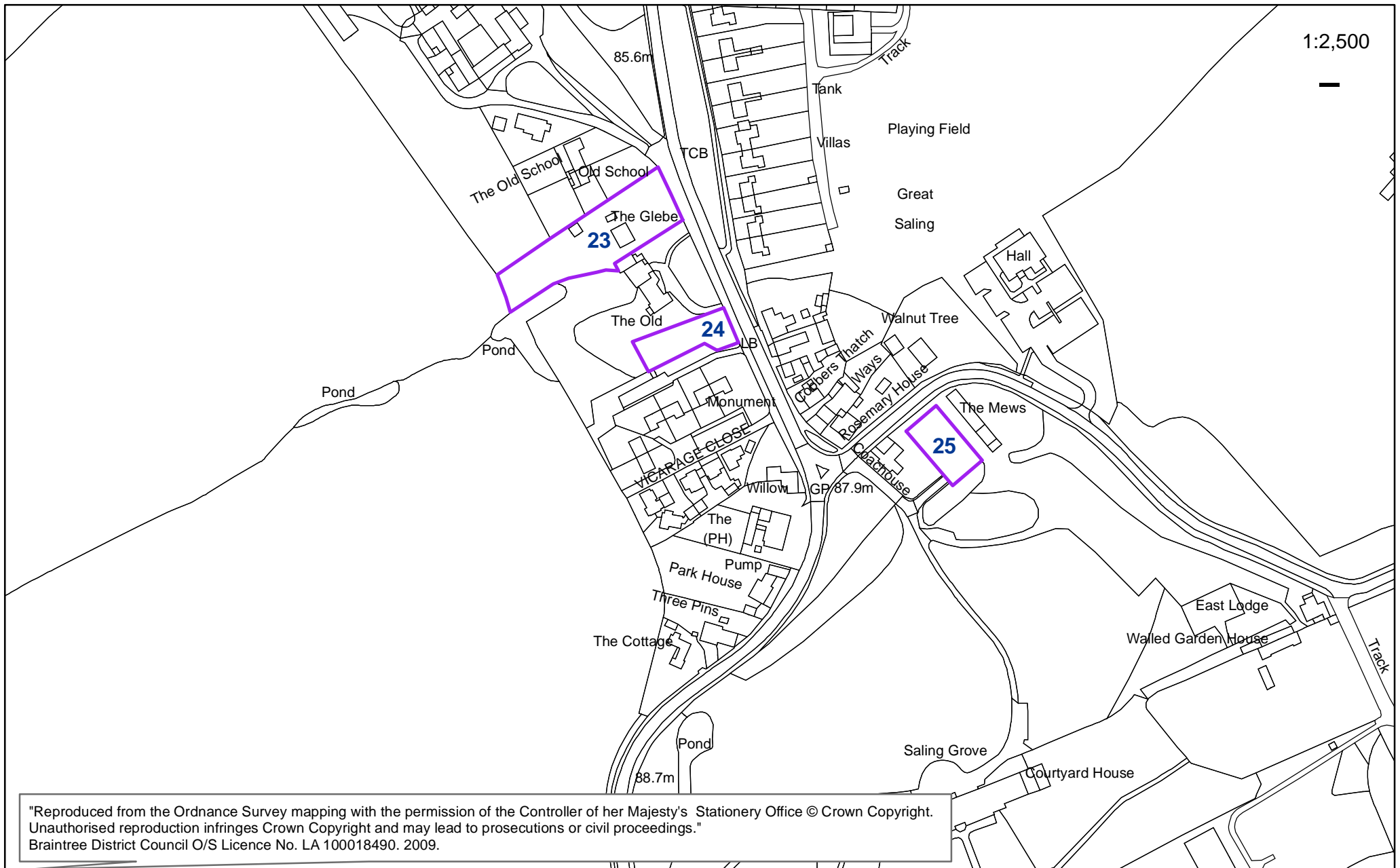

- 23 - The Glebe, The Street, Gt Saling
- 24 - Part grounds The Vicarage, The Street
- 25 - The Coach House, Saling Grove

**Key**

- SITES WITHOUT PLANNING PERMISSION
- SITES WITH PLANNING PERMISSION