

**RESIDENTIAL LAND AVAILABILITY
PARISH: SIBLE HEDINGHAM**

DWELLING SITES AS AT: 31.3.11

According to revised PDL
definition as at June 2010:
Dwelling plots on

Map site ref. no.	Location of site	Planning application reference where relevant	Estimated dwelling sites without planning permission	Dwelling sites with planning permission			Total all dwelling sites with planning permission	Sum total all dwelling sites with or without planning permission	Previously developed land	Greenfield	
				Total site capacity (including built)	Dwellings not started						
				With outline plg.perm.	With full plg.perm.	Dwellings under construction					
15	Rectory Meadow final phase plots 20, 21 o/s	937/91			3		3	3	0	3	
69	Adj The Village Hall	1469/04			8		8	8	0	8	
91	Land adj 1 Hawkswood Road	669/07				1	1	1	0	1	
95	Land at Alleys Yard adj 45-49 Swan St	449/05				1	1	1	1	0	
96	Adj Sandpipers 83 Alexandra Rd	424/05				1	1	1	0	1	
103	Oaklands High Street Green	1924/08			1		1	1	1	0	
110	Workshop at Cobbs Fenn	1182/10			1		1	1	1	0	
114	Land rear of 1 Spurgeon Close	1165/07				1	1	1	0	1	
115	Land rear of 133/135 Swan Street	1382/10			4		4	4	1	3	
116	Oak House Morris Green Road	2093/08			1		1	1	1	0	
117	Barn at Tilekiln Farm A1017	186/09			1		1	1	0	1	
118	Alderford Farm Alderford Street	030/10			1		1	1	1	0	
119	Land rear of 132, 134, 136 Swan Street	096/09			2		2	2	0	2	
120	Premdor site & Rockways Station Road, (mixed use site)		230				0	230	230	0	
121	Coopers yard Swan Street		12				0	12	12	0	
122	Former Corders Builders yard and backlands north of Alexandra Road		5				0	5	5	0	
123	Land adjacent 35 Station Road		6				0	6	6	0	
124	Garage between 8 and 10 Station Road	1137/10		1	1		1	1	1	0	
125	165/167 Swan Street		8				0	8	8	0	
126	Parking Court Oxford Meadows		2				0	2	2	0	
127	73 Swan Street	1590/10		2	2		2	2	2	0	
128	First floor 16 Swan Street	989/10		1	1		1	1	1	0	
Gross Total			263		1	22	7	30	293	273	20
<i>Losses</i>											
116	Oak House Morris Green Road	2093/08		1	-1		-1	-1	-1	0	

**RESIDENTIAL LAND AVAILABILITY
PARISH: SIBLE HEDINGHAM**

DWELLING SITES AS AT: 31.3.11

According to revised PDL
definition as at June 2010:
Dwelling plots on

Map site ref. no.	Location of site	Planning application reference where relevant	Estimated dwelling sites without planning permission	Dwelling sites with planning permission			Total all dwelling sites with planning permission	Sum total all dwelling sites with or without planning permission	Previously developed land	Greenfield
				Total site capacity (including built)	Dwellings not started					
				With outline plg.perm.	With full plg.perm.	Dwellings under construction				
118	Alderford Farm Alderford Street	30/10		1		-1	-1	-1	-1	0
<i>Total Losses</i>			0	0	-2	0	-2	-2	-2	0
Net Total			263	1	20	7	28	291	271	20

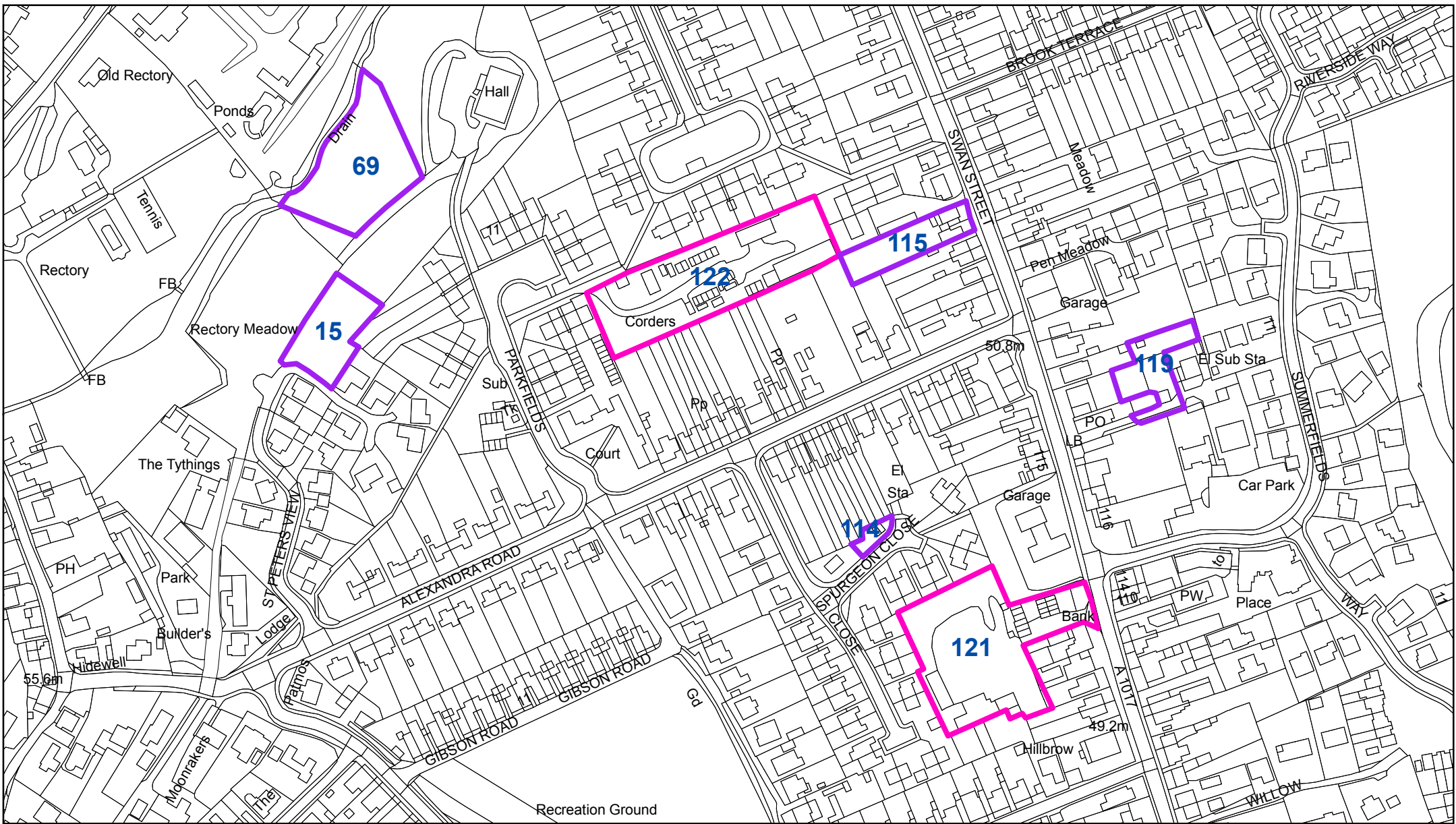

Sible Hedingham:

15 - Rectory Meadow

69 - Adj The Village Hall

114 - Land rear of 1 Spurgeon Close

115 - Land rear of 133/135 Swan Street

119 - Land rear of 132, 134, 136 Swan Street

121 - Coopers Yard Swan Street

122 - Former Corders Builders Yard and backlands north of Alexandra Road

"Reproduced from the Ordnance Survey mapping with the permission of the Controller of her Majesty's Stationery Office © Crown Copyright. Unauthorised reproduction infringes Crown Copyright and may lead to prosecutions or civil proceedings."

Braintree District Council O/S Licence No. LA 100018490. 2011

Key

 Sites with planning permission

 Sites without planning permission



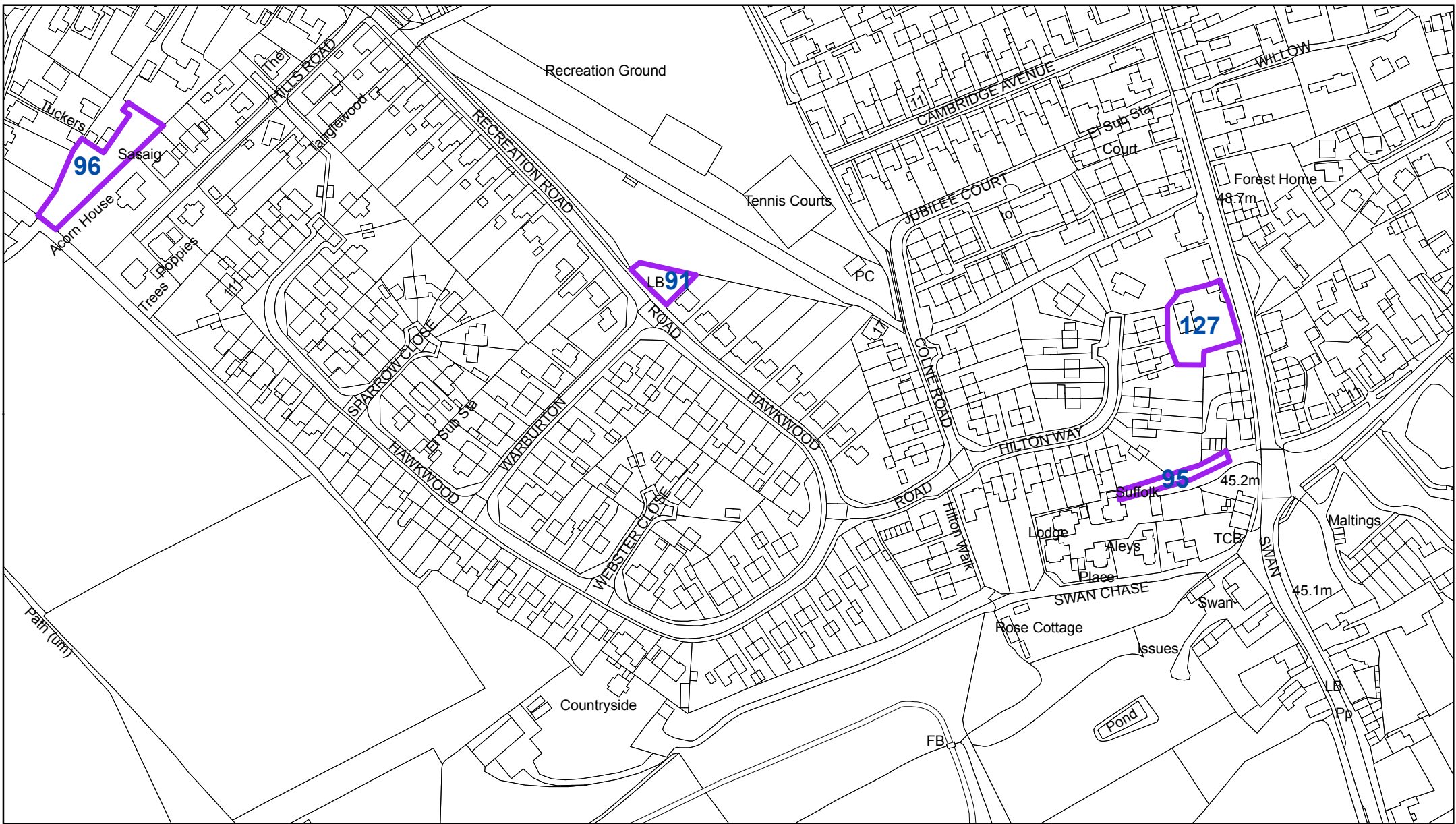

Sible Hedingham:

- 91 - Land adj 1 Hawkswood Road
- 95 - Land at Alleys Yard adj 45-49 Swan Street
- 96 - Adj Sandpipers, 83 Alexandra Road
- 127 - 73 Swan Street

"Reproduced from the Ordnance Survey mapping with the permission of the Controller of her Majesty's Stationery Office © Crown Copyright. Unauthorised reproduction infringes Crown Copyright and may lead to prosecutions or civil proceedings." Braintree District Council O/S Licence No. LA 100018490. 2011

Key

- Sites with planning permission
- Sites without planning permission



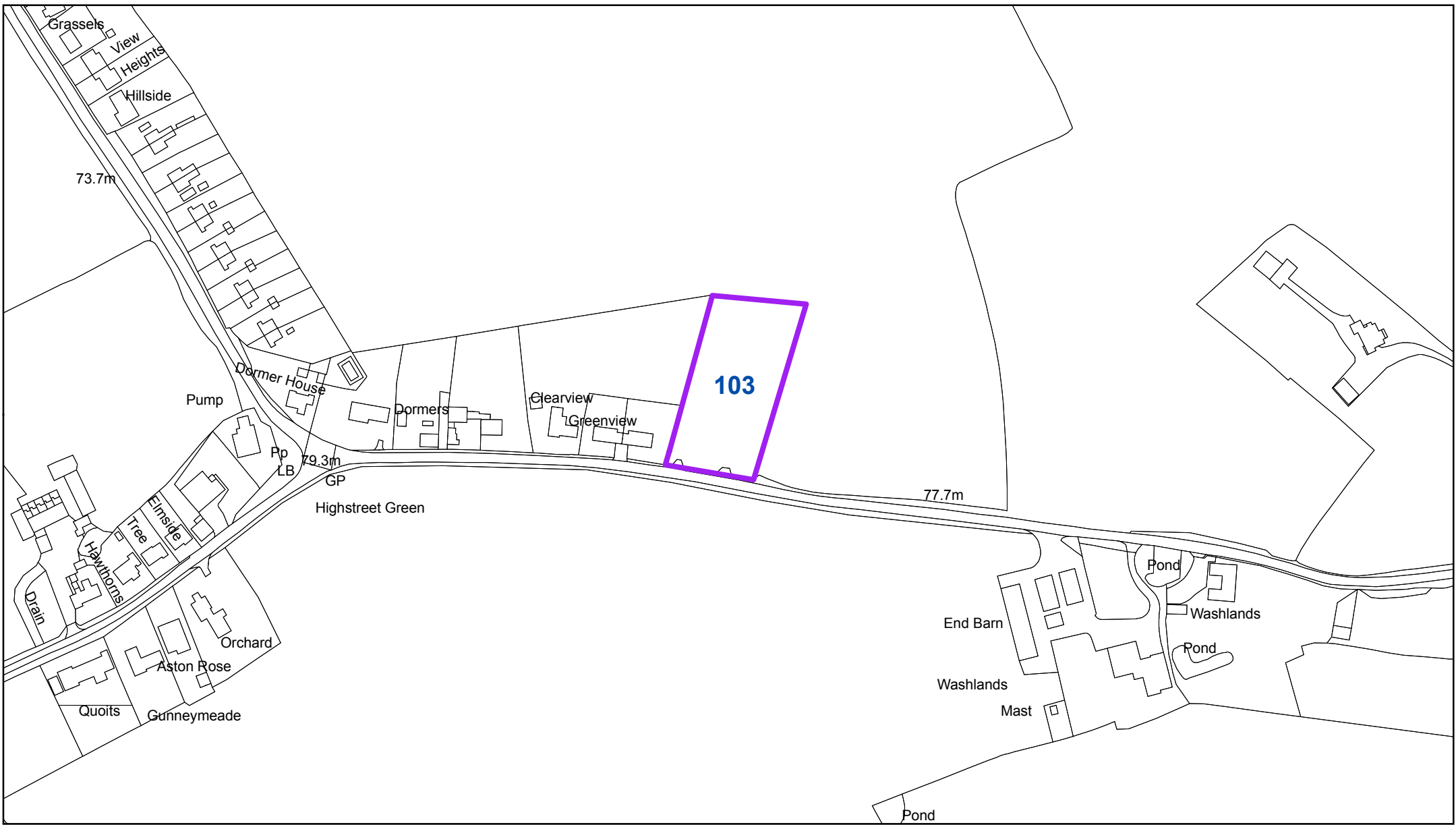

Sible Hedingham:
103 - Oaklands, High Street Green

"Reproduced from the Ordnance Survey mapping with the permission of the Controller of her Majesty's Stationery Office © Crown Copyright. Unauthorised reproduction infringes Crown Copyright and may lead to prosecutions or civil proceedings." Braintree District Council O/S Licence No. LA 100018490. 2011

Key

- Sites with planning permission
- Sites without planning permission



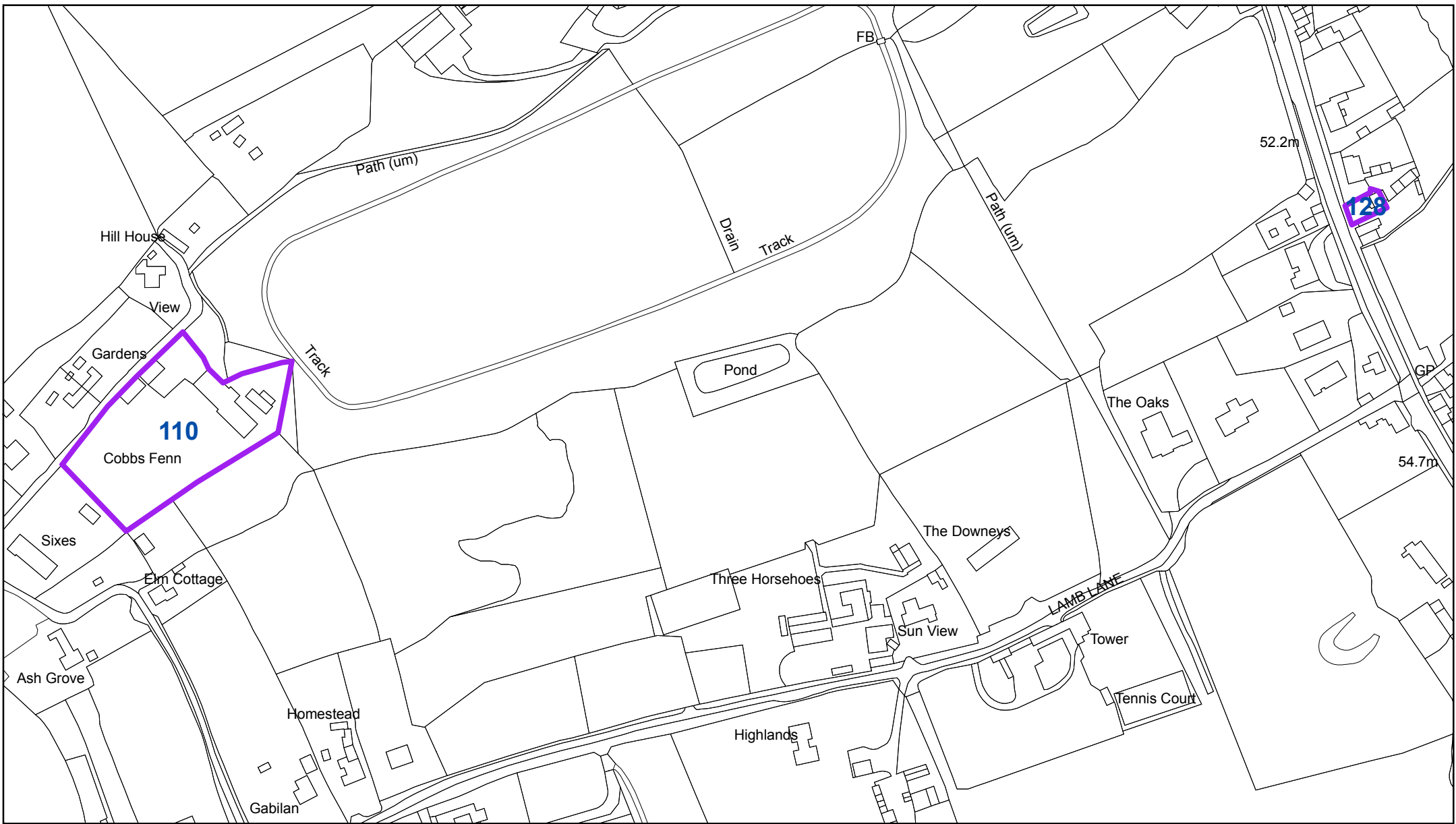

Sible Hedingham:
 110 - Workshop at Cobbs Fenn
 128 - First Floor, 16 Swan Street

"Reproduced from the Ordnance Survey mapping with the permission of the Controller of her Majesty's Stationery Office © Crown Copyright. Unauthorised reproduction infringes Crown Copyright and may lead to prosecutions or civil proceedings."
 Braintree District Council O/S Licence No. LA 100018490. 2011

Key

- Sites with planning permission
- Sites without planning permission

N

 1:2,500

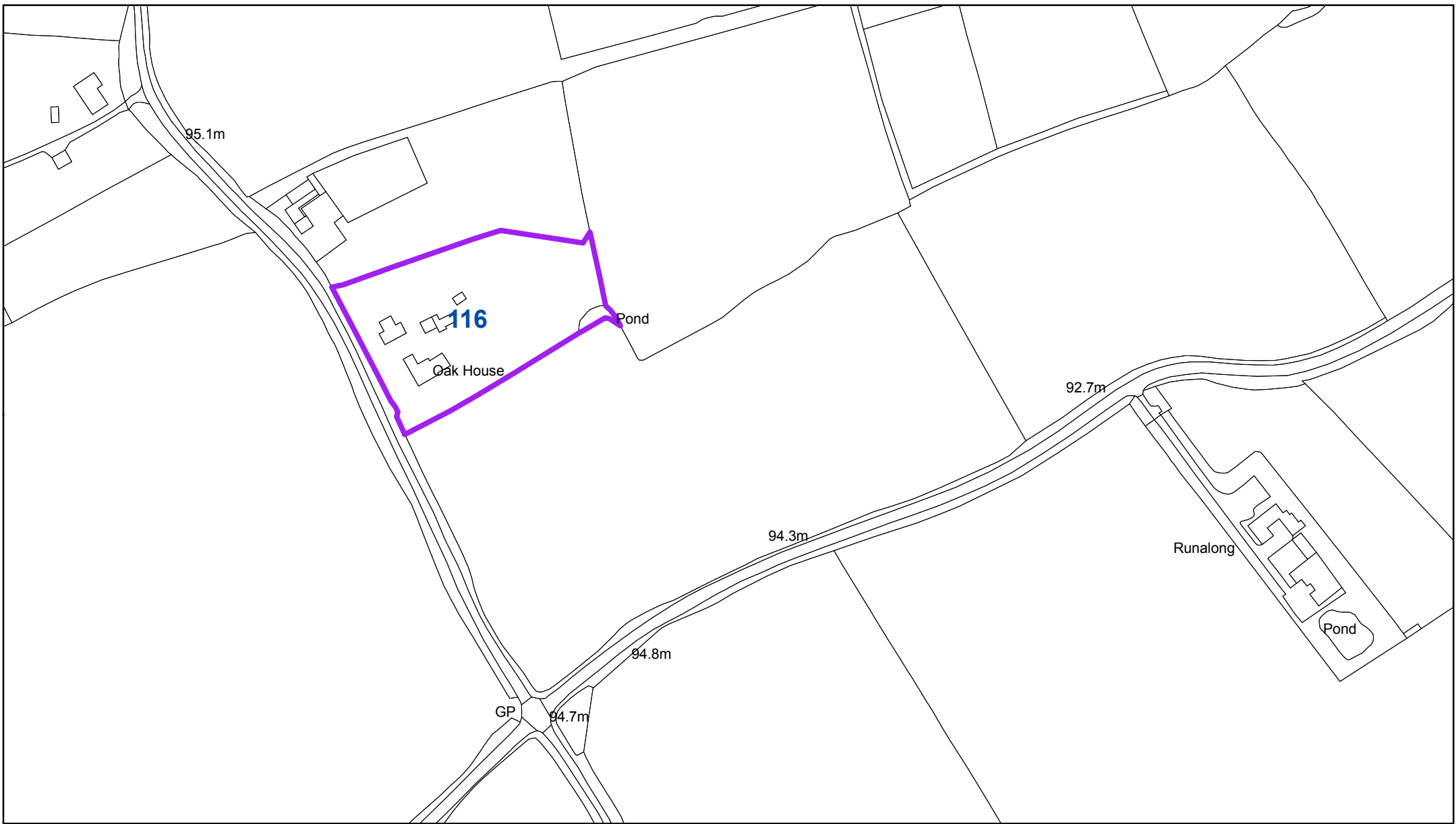

Sible Hedingham:
116 - Oak House, Morris Green Road

"Reproduced from the Ordnance Survey mapping with the permission of the Controller of her Majesty's Stationery Office © Crown Copyright. Unauthorised reproduction infringes Crown Copyright and may lead to prosecutions or civil proceedings."
Braintree District Council O/S Licence No. LA 100018490. 2011

Key

- Sites with planning permission
- Sites without planning permission



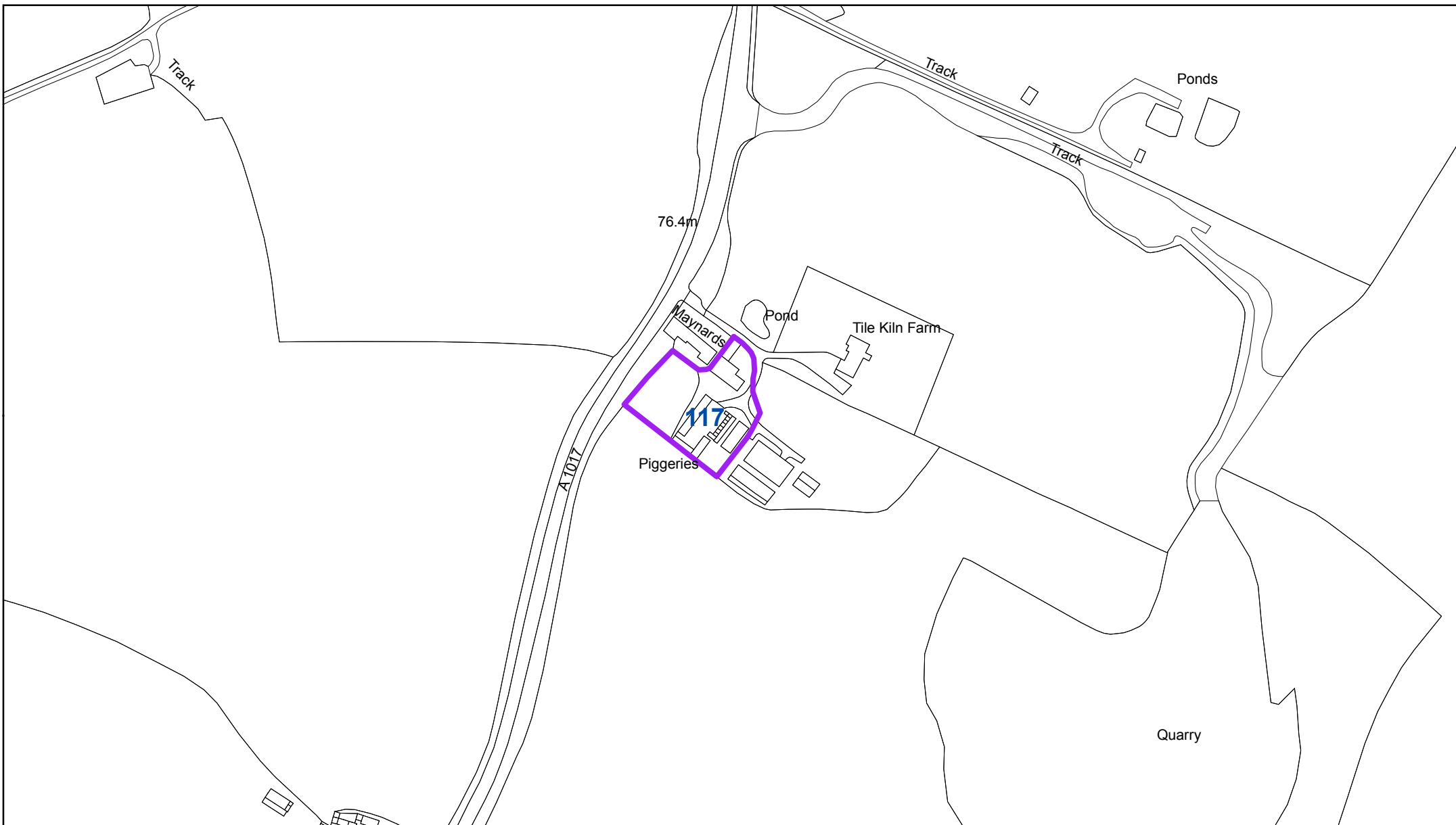

Sible Hedingham:
117 - Barn at Tilekiln Farm A1017

Key

- Sites with planning permission
- Sites without planning permission

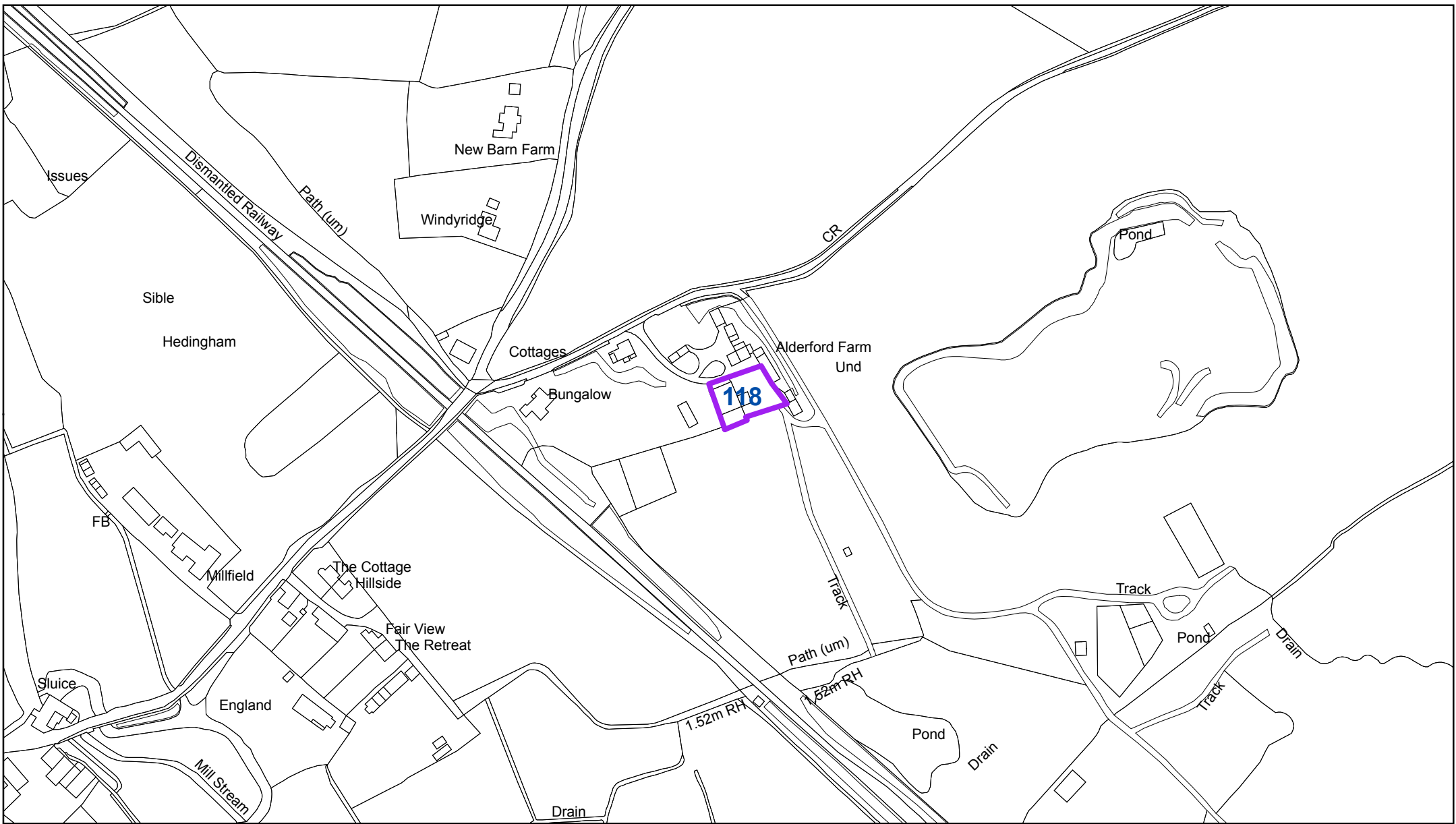

Sible Hedingham:
118 - Alderford Farm, Alderford Street

Key

- Sites with planning permission
- Sites without planning permission

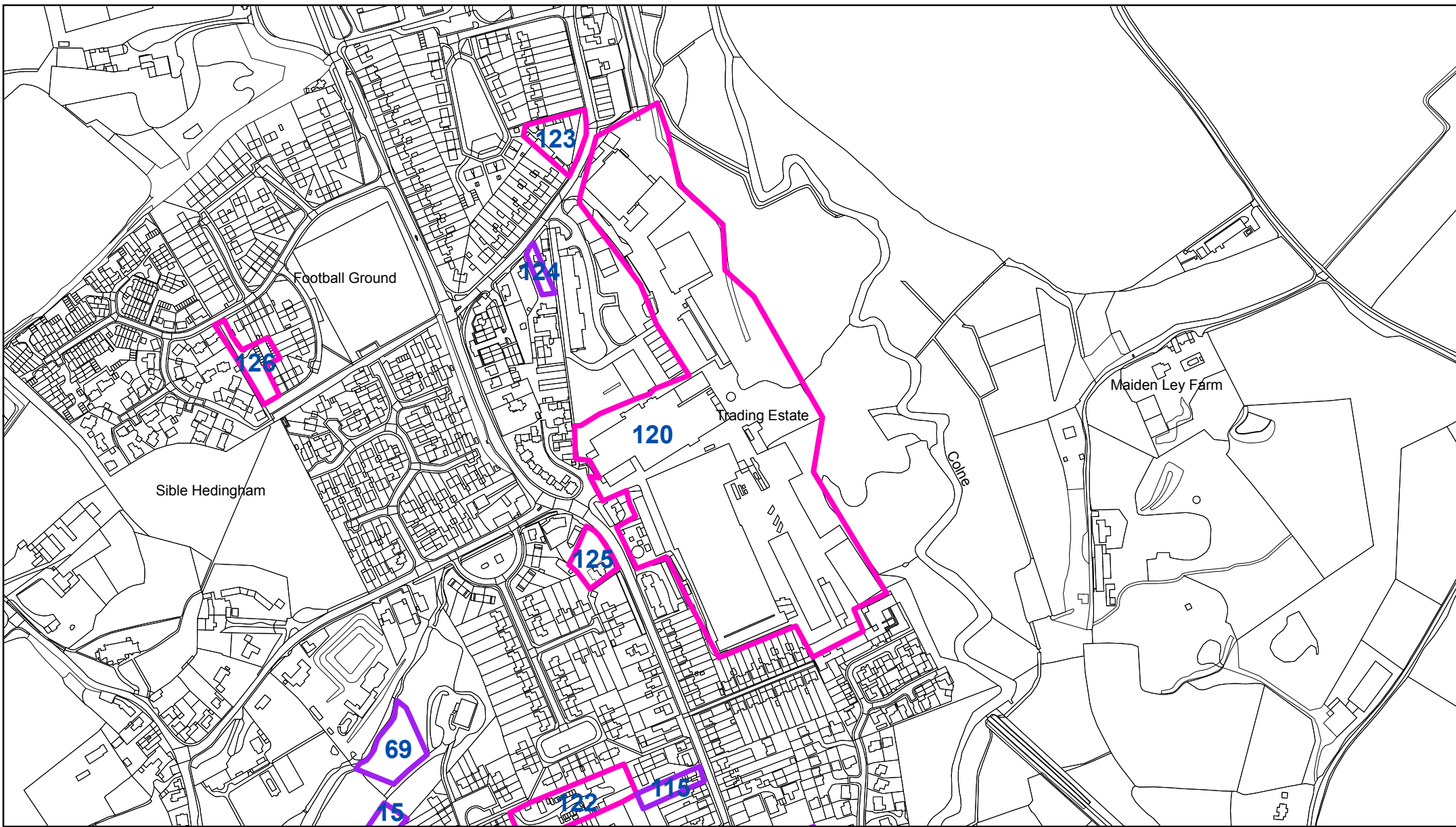

Sible Hedingham:
120 - Premdor site & Rockways, Station Road (mixed use site)

"Reproduced from the Ordnance Survey mapping with the permission of the Controller of her Majesty's Stationery Office © Crown Copyright. Unauthorised reproduction infringes Crown Copyright and may lead to prosecutions or civil proceedings." Braintree District Council O/S Licence No. LA 100018490. 2011

Key

- Sites with planning permission
- Sites without planning permission

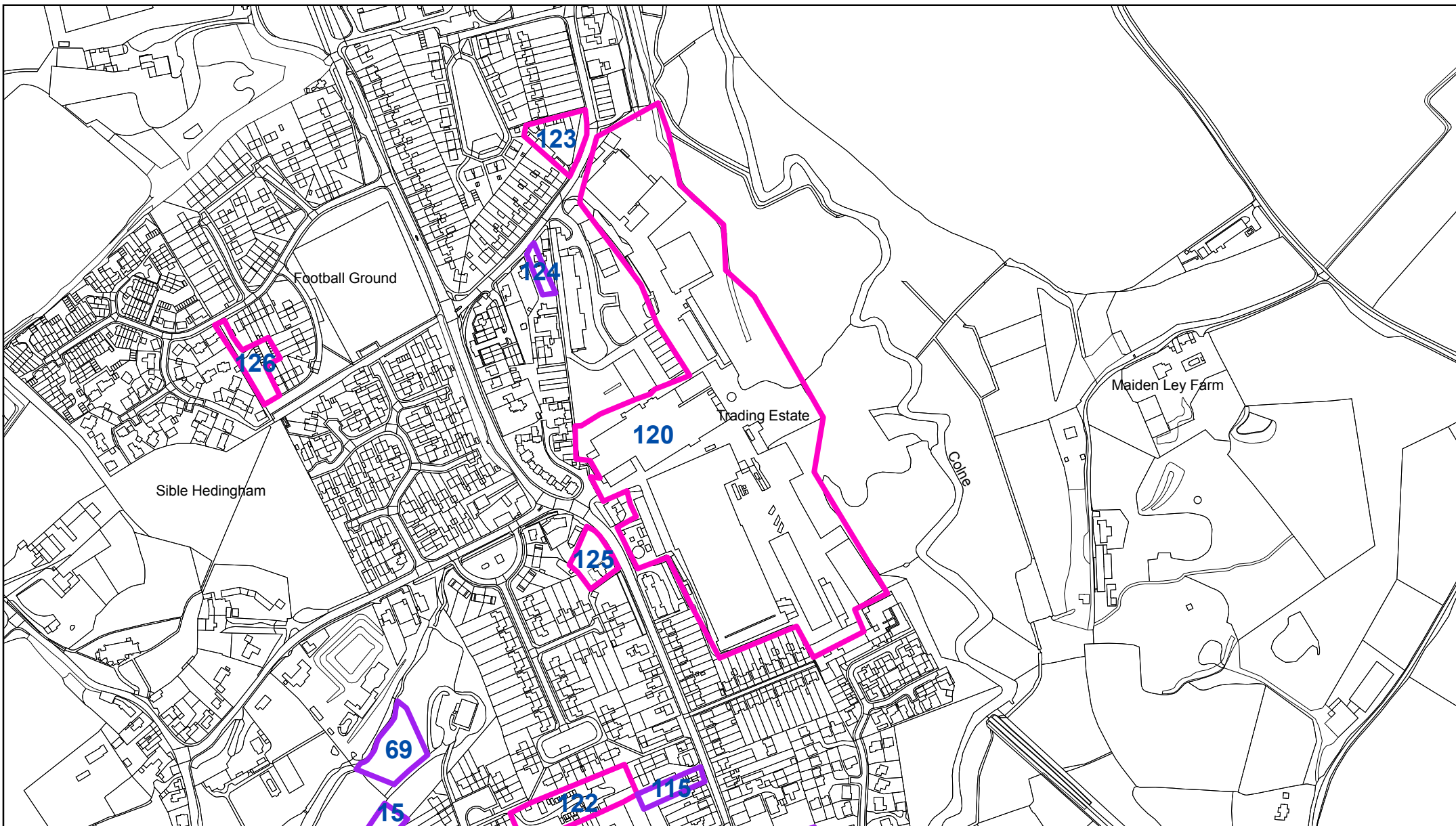

Sible Hedingham:

120 - Premdor site & Rockways, Station Road (mixed use site)

123 - Land adjacent 35 Station Road

124 - Garage between 8 and 10 Station Road

125 - 165/167 Swan Street

126 - Parking Court, Oxford Meadows

"Reproduced from the Ordnance Survey mapping with the permission of the Controller of her Majesty's Stationery Office © Crown Copyright. Unauthorised reproduction infringes Crown Copyright and may lead to prosecutions or civil proceedings."

Braintree District Council O/S Licence No. LA 100018490. 2011

Key

 Sites with planning permission

 Sites without planning permission



1:5,000