

RESIDENTIAL LAND AVAILABILITY
PARISH: BOCKING SOUTH

DWELLING SITES AS AT: 31.3.10

Map site ref. no.	Location of site	Planning application reference where relevant	Estimated dwelling sites without planning permission	Dwelling sites with planning permission				Total all dwelling sites with planning permission	Sum total all dwelling sites with or without planning permission	According to PDL definition as at April 2010: Dwelling plots on		According to revised PDL definition as at June 2010: Dwelling plots on	
				Total site capacity (including built)	Dwellings not started		Dwellings under construction			Previously developed land	Greenfield	Previously developed land	Greenfield
					With outline plg.perm.	With full plg.perm.							
489a	Land off Tenter Close	439/09		6	6			6	6	0	6	0	6
489b	Land rear of 49-57 Church Lane		9					0	9	0	9	0	9
597	Ex garage court land south of 83 Tabor Ave (HA)	2323/07		5		5		5	5	5	0	5	0
599	10 Crittall Drive	2053/07		1		1		1	1	1	0	1	0
600	Land off Williams Drive	1912/06		14		9	5	14	14	14	0	14	0
616	Land rear of 39 Bradford Street	1016/09		1			1	1	1	1	0	0	1
617	Barn rear of 17 and 19 Bradford Street	2070/08		1			1	1	1	1	0	1	0
643	Former DWP offices Panfield Lane		14					0	14	14	0	14	0
644	Garage court off Coldnailhurst Avenue		3					0	3	3	0	3	0
645	Ratcliffes haulage yard Panfield Lane		1					0	1	1	0	1	0
646	Cornell furniture centre Panfield Lane		6					0	6	6	0	6	0
Gross total:			33		6	15	7	28	61	46	15	45	16
<i>Losses:</i>													
<i>Total losses:</i>			0		0	0	0	0	0	0	0	0	0
Net total			33		6	15	7	28	61	46	15	45	16

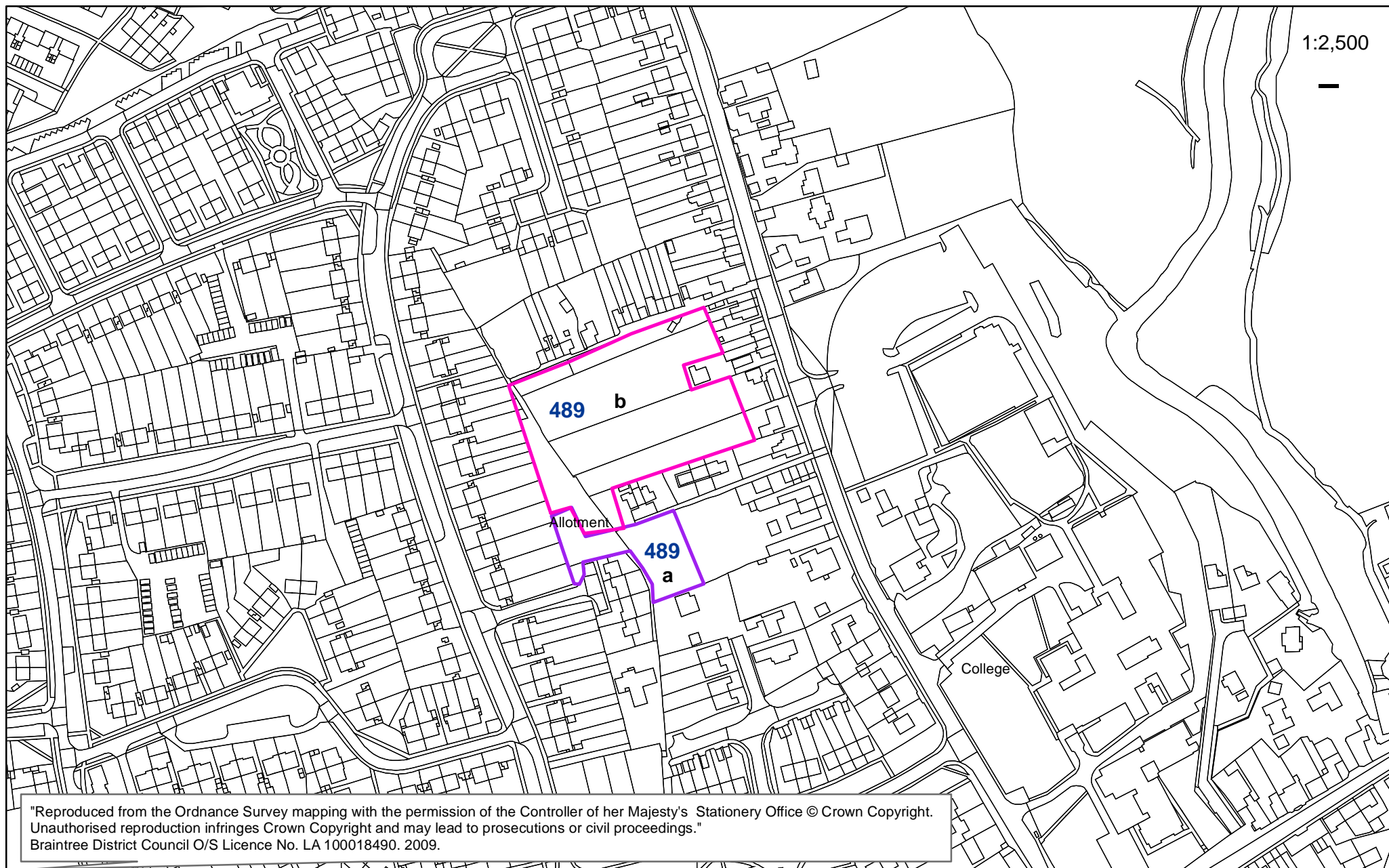

1:2,500



"Reproduced from the Ordnance Survey mapping with the permission of the Controller of her Majesty's Stationery Office © Crown Copyright. Unauthorised reproduction infringes Crown Copyright and may lead to prosecutions or civil proceedings." Braintree District Council O/S Licence No. LA 100018490. 2009.

489a - Land off Tenter Close, Bocking South
489b - Land rear of 49-57 Church Lane

Key

-  SITES WITHOUT PLANNING PERMISSION
-  SITES WITH PLANNING PERMISSION

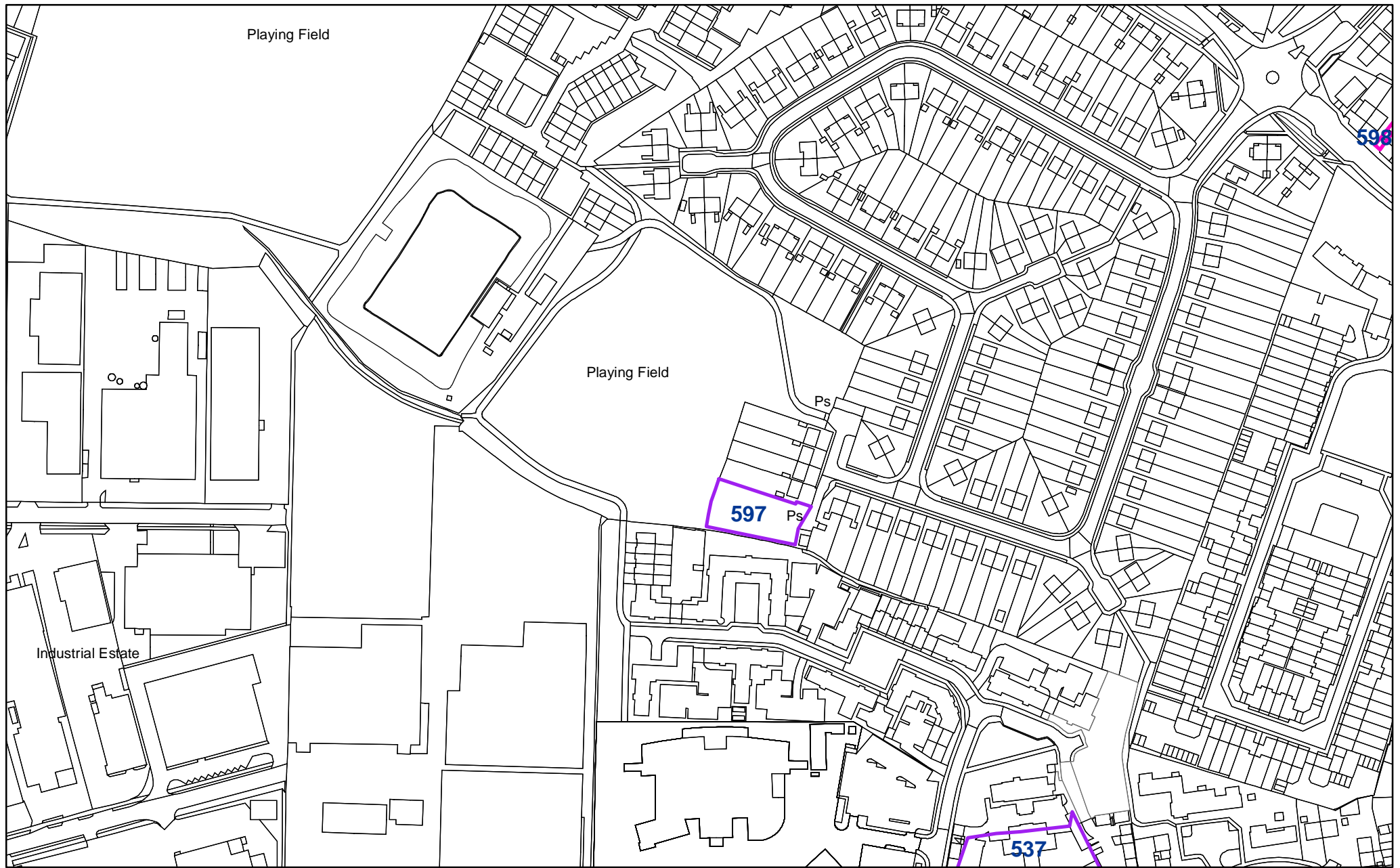

597 - Ex garage court land south of 83 Tabor Ave (HA) Bocking South

1:2,500

"Reproduced from the Ordnance Survey mapping with the permission of the Controller of her Majesty's Stationery Office © Crown Copyright. Unauthorised reproduction infringes Crown Copyright and may lead to prosecutions or civil proceedings."
Braintree District Council O/S Licence No. LA 100018490. 2009.

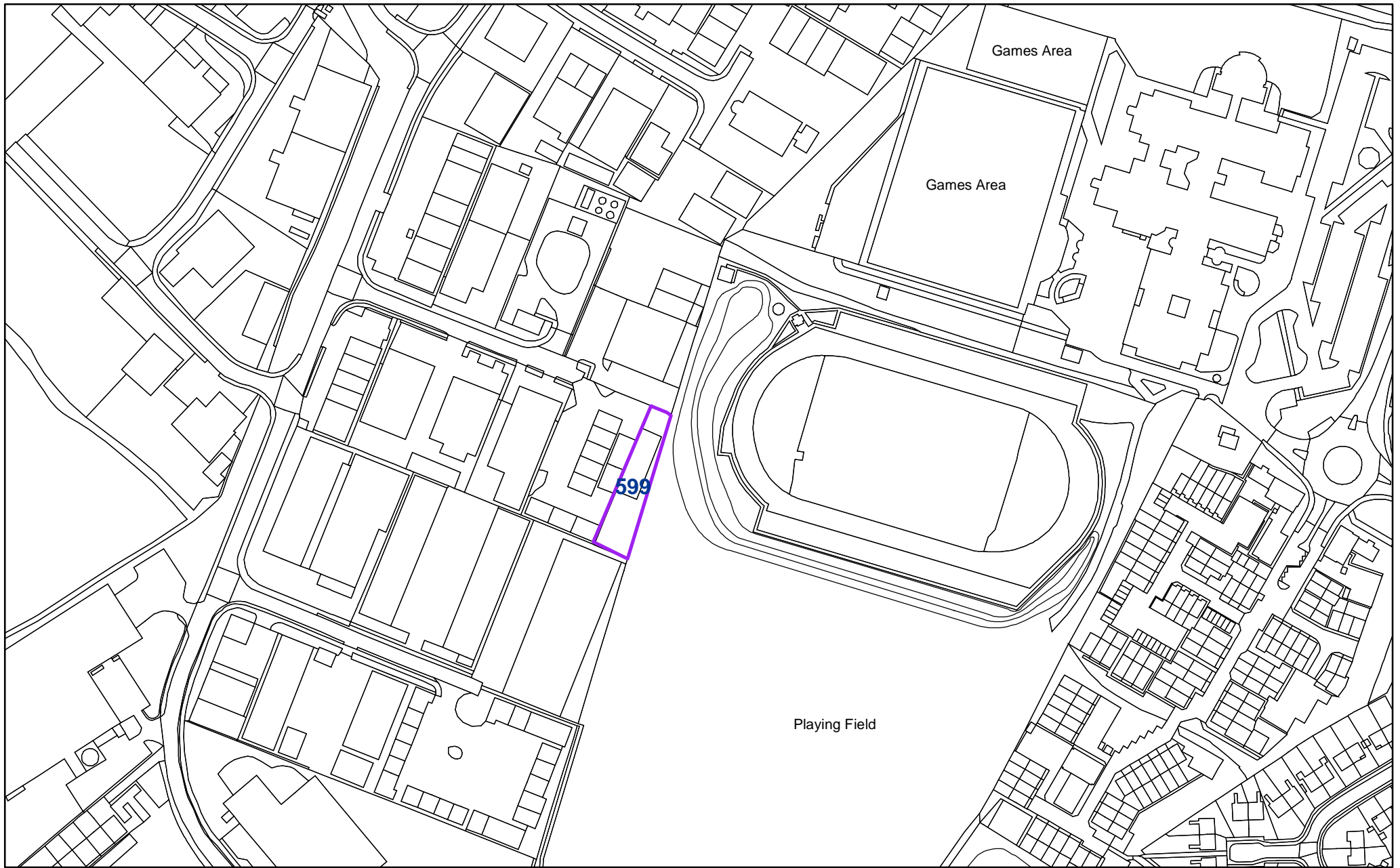

599 - 10 Crittal Drive, Bocking South

1:2,500

"Reproduced from the Ordnance Survey mapping with the permission of the Controller of her Majesty's Stationery Office © Crown Copyright. Unauthorised reproduction infringes Crown Copyright and may lead to prosecutions or civil proceedings."
Braintree District Council O/S Licence No. LA 100018490. 2009.

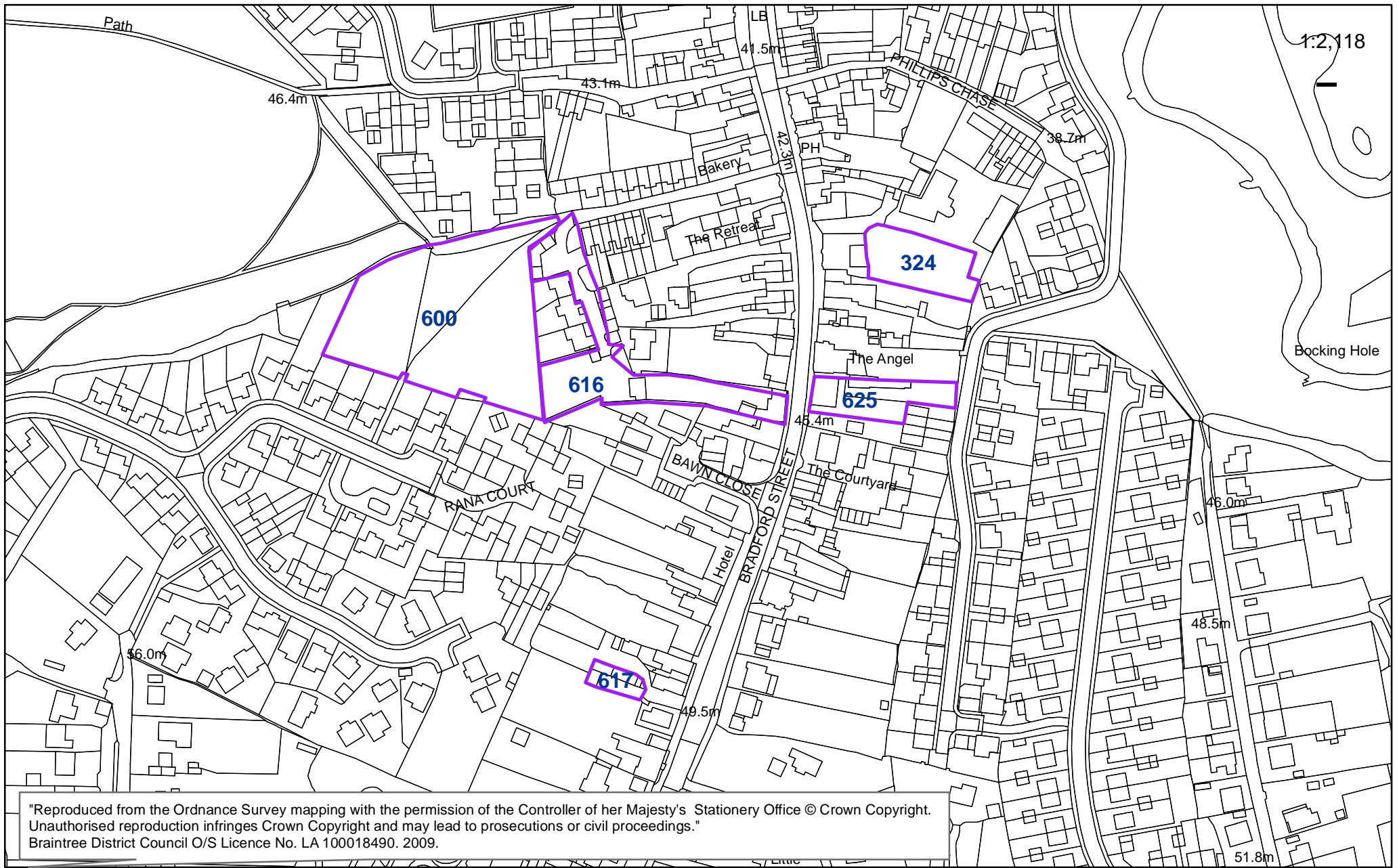

"Reproduced from the Ordnance Survey mapping with the permission of the Controller of her Majesty's Stationery Office © Crown Copyright. Unauthorised reproduction infringes Crown Copyright and may lead to prosecutions or civil proceedings." Braintree District Council O/S Licence No. LA 100018490. 2009.

- 600 - Land off Williams Drive, Bocking South
- 616 - Land rear of 39 Bradford Street
- 617 - Barn rear of 17 and 19 Bradford Street

Key

- SITES WITHOUT PLANNING PERMISSION
- SITES WITH PLANNING PERMISSION

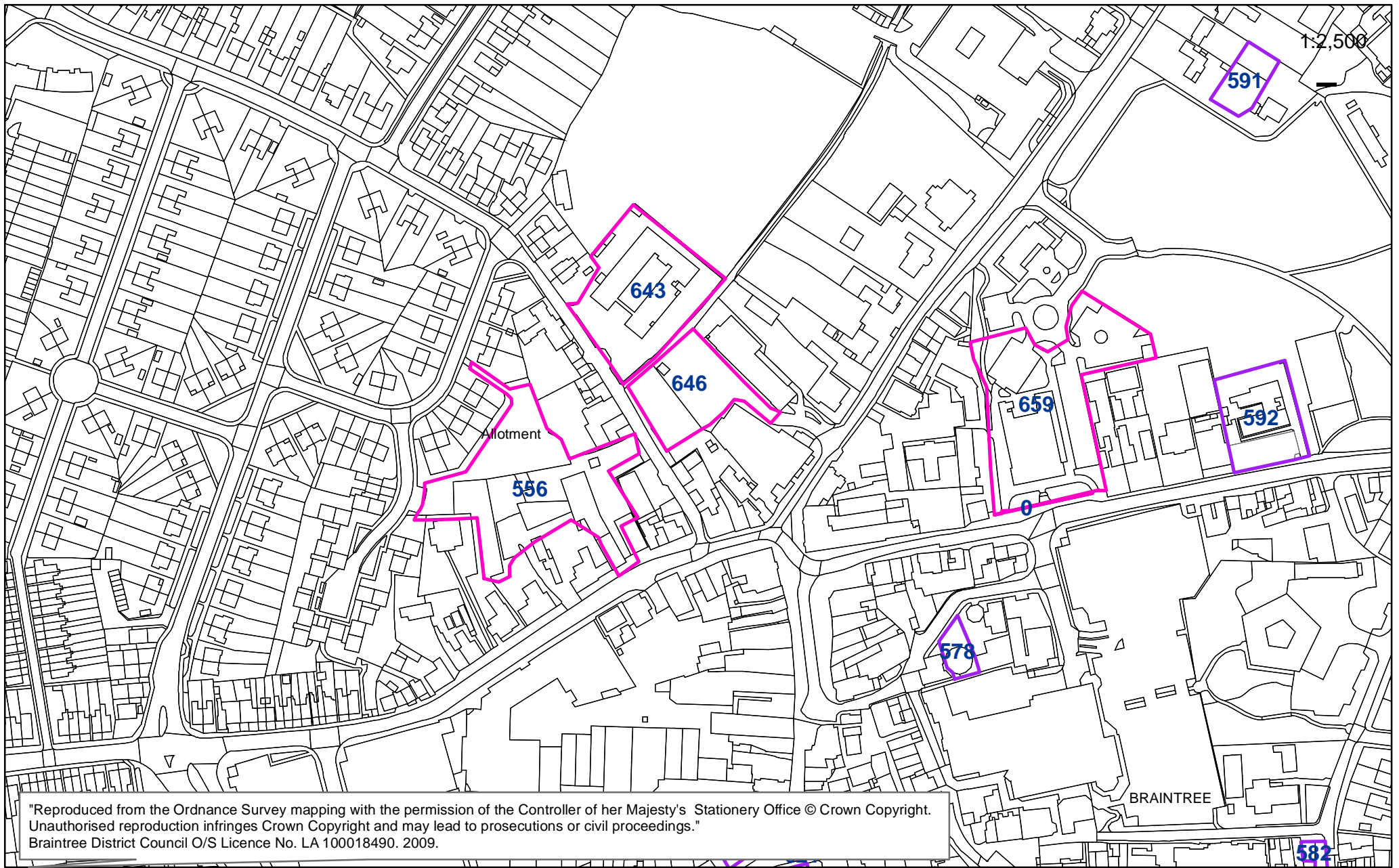

643 - Former DWP offices Panfield Lane, Bocking South
 646 - Cornell furniture centre Panfield Lane

Key

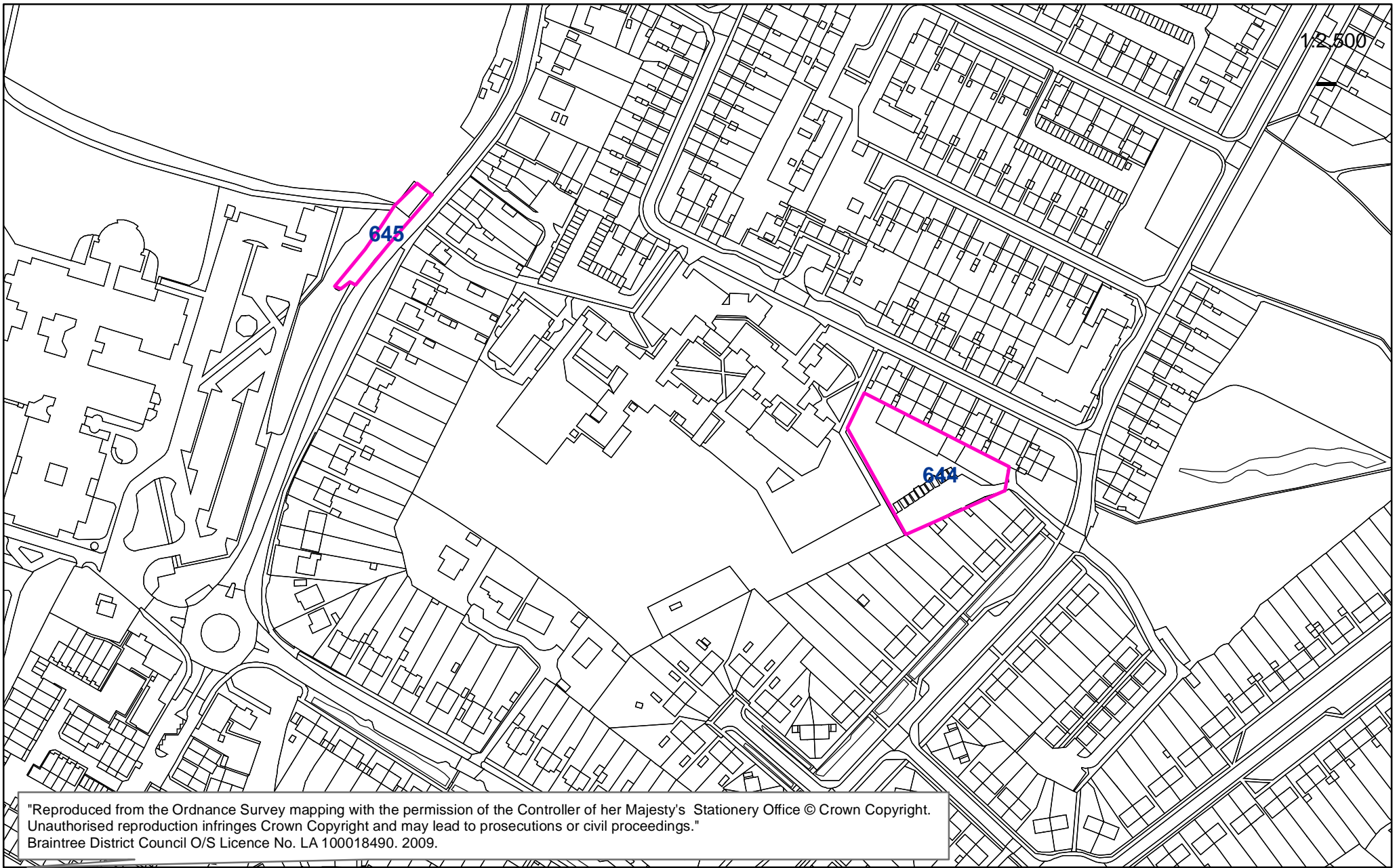

- SITES WITHOUT PLANNING PERMISSION
- SITES WITH PLANNING PERMISSION



"Reproduced from the Ordnance Survey mapping with the permission of the Controller of her Majesty's Stationery Office © Crown Copyright. Unauthorised reproduction infringes Crown Copyright and may lead to prosecutions or civil proceedings." Braintree District Council O/S Licence No. LA 100018490. 2009.

644 - Garage court off Coldnailhurst Avenue, Bocking South
645 - Ratcliffes haulage yard, Panfield Lane

Key

-  SITES WITHOUT PLANNING PERMISSION
-  SITES WITH PLANNING PERMISSION