

**RESIDENTIAL LAND AVAILABILITY
PARISH: SHALFORD**

DWELLING SITES AS AT: 31.3.11

According to revised PDL
definition as at June
2010: Dwelling plots on

Map site ref. no.	Location of site	Planning application reference where relevant	Estimated dwelling sites without planning permission	Dwelling sites with planning permission				Total all dwelling sites with planning permission	Sum total all dwelling sites with or without planning permission	Previously developed land	Greenfield
				Total Dwellings not started site capacity (including built)	With outline plg.perm.	With full plg.perm.	Dwellings under construction				
42	Tan House Barn Iron Bridge Lane	1159/10		1		1		1	1	0	1
43	Poplar Cottage Church End	2101/08		2			1	1	1	1	0
44	Deersbrook Farm Shalford Green Road	1135/09		1	1			1	1	0	1
45	Builders yard Braintree Road	1116/09		9		9		9	9	9	0
46	Land opposite Alwynds, Braintree Road (Hsg Assoc)	955/09		8			8	8	8	0	8
47	Part garden Windyridge Cliff Crescent	838/10		1		1		1	1	0	1
Gross total:			0		1	11	9	21	21	10	11
<i>Losses:</i>											
<i>Total losses:</i>			0		0	0	0	0	0	0	0
Net total:			0		1	11	9	21	21	10	11

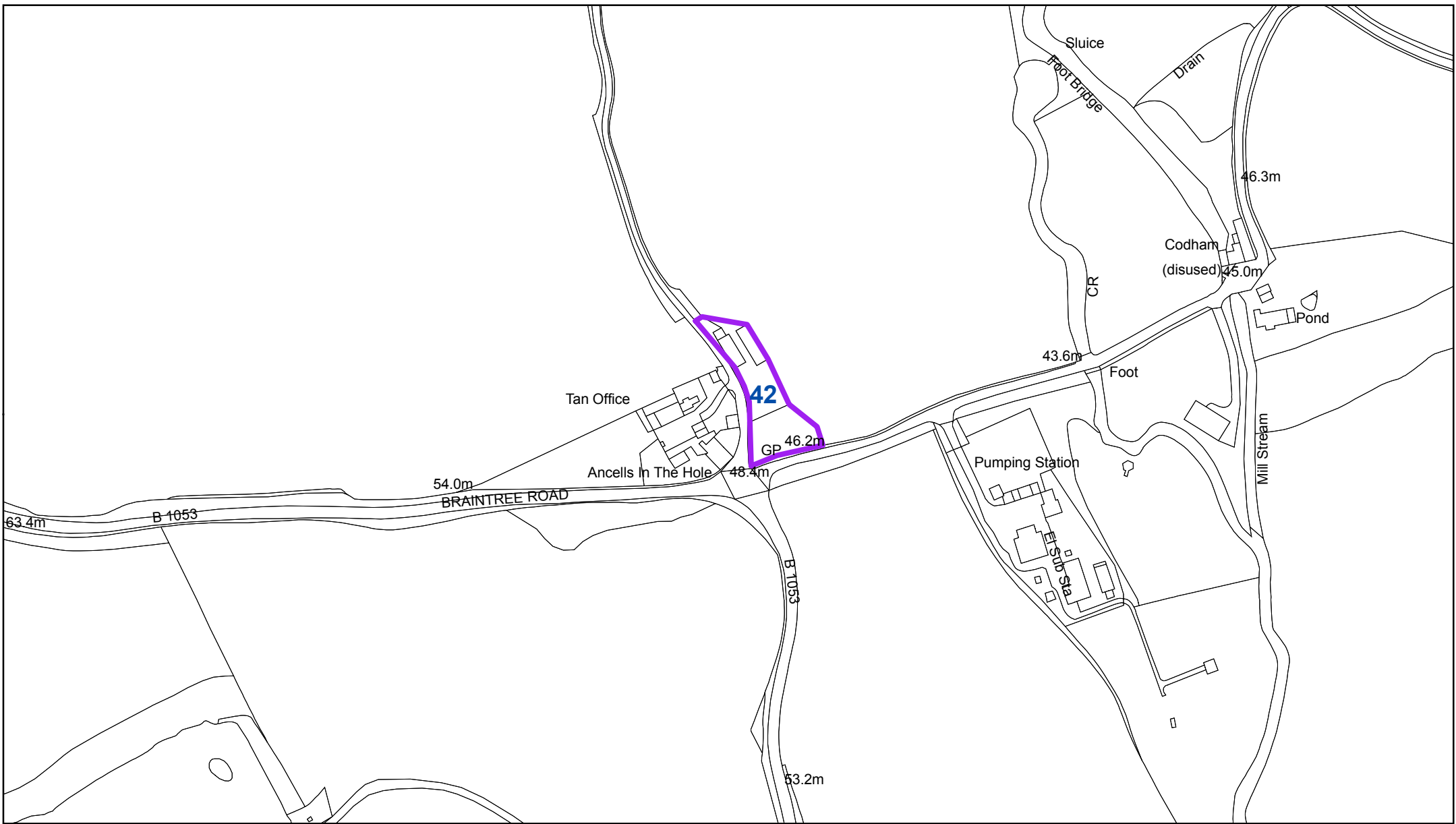

Shalford:
42 - Tan House Barn, Iron Bridge Lane

"Reproduced from the Ordnance Survey mapping with the permission of the Controller of her Majesty's Stationery Office © Crown Copyright. Unauthorised reproduction infringes Crown Copyright and may lead to prosecutions or civil proceedings."
Braintree District Council O/S Licence No. LA 100018490. 2011

Key

- Sites with planning permission
- Sites without planning permission



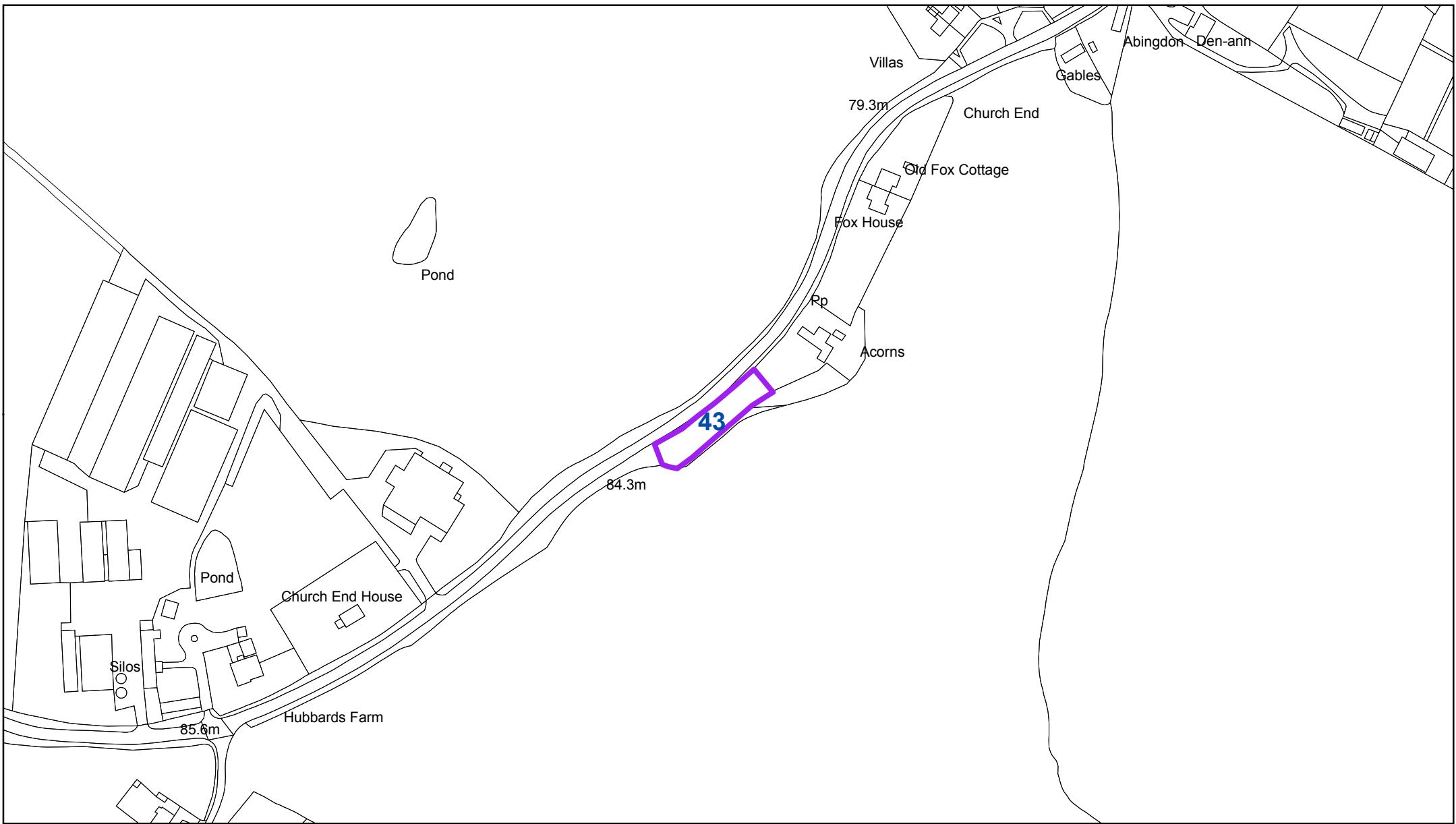

Shalford:
43 - Poplar Cottage, Church End

Key

- Sites with planning permission
- Sites without planning permission

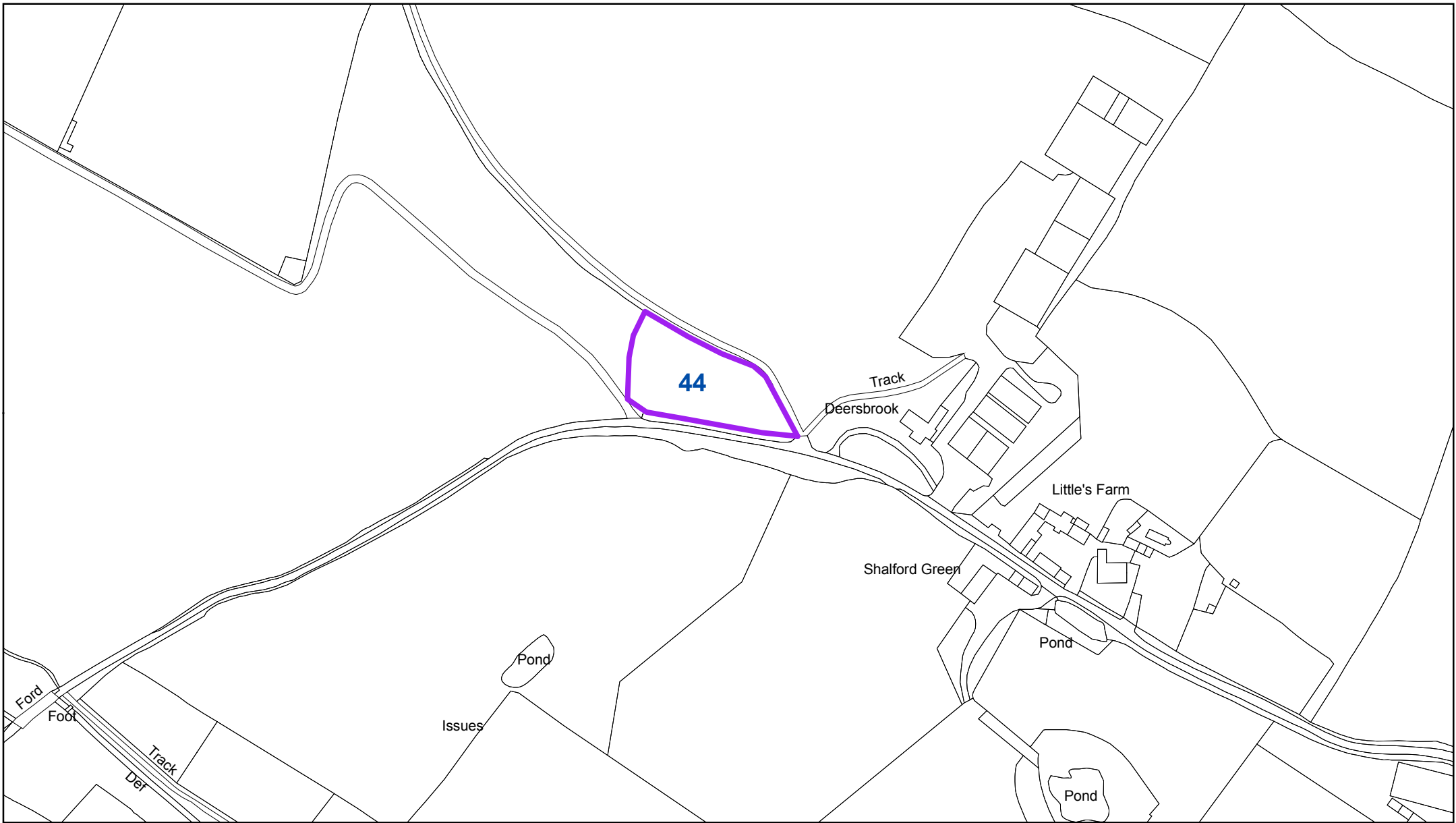

Shalford:
44 - Deersbrook Farm, Shalford Green Road

"Reproduced from the Ordnance Survey mapping with the permission of the Controller of her Majesty's Stationery Office © Crown Copyright. Unauthorised reproduction infringes Crown Copyright and may lead to prosecutions or civil proceedings."
Braintree District Council O/S Licence No. LA 100018490. 2011

Key

-  Sites with planning permission
-  Sites without planning permission



