

**RESIDENTIAL LAND AVAILABILITY
PARISH: HELIONS BUMPSTEAD**

DWELLING SITES AS AT: 31.3.11

According to revised PDL
definition as at June
2010: Dwelling plots on

Map site ref. no.	Location of site	Planning application reference where relevant	Estimated dwelling sites without planning permission	Dwelling sites with planning permission				Total all dwelling sites with planning permission	Sum total all dwelling sites with or without planning permission	Previously developed land	Greenfield
				Total site capacity (including built)	Dwellings not started		Dwellings under construction				
					With outline plg.perm.	With full plg.perm.					
26	Barn at Helions Farm Sages End	1300/09		2		1	1	2	2	0	2
28	Crossroads Water Lane	2485/07	2					0	2	2	0
Gross total			2		0	1	1	2	4	2	2
<i>Losses</i>											
28	<i>Crossroads Water Lane</i>	<i>2485/07</i>	<i>-1</i>					<i>0</i>	<i>-1</i>	<i>-1</i>	<i>0</i>
Total losses			<i>-1</i>		<i>0</i>	<i>0</i>	<i>0</i>	<i>0</i>	<i>-1</i>	<i>-1</i>	<i>0</i>
Total			1		0	1	1	2	3	1	2

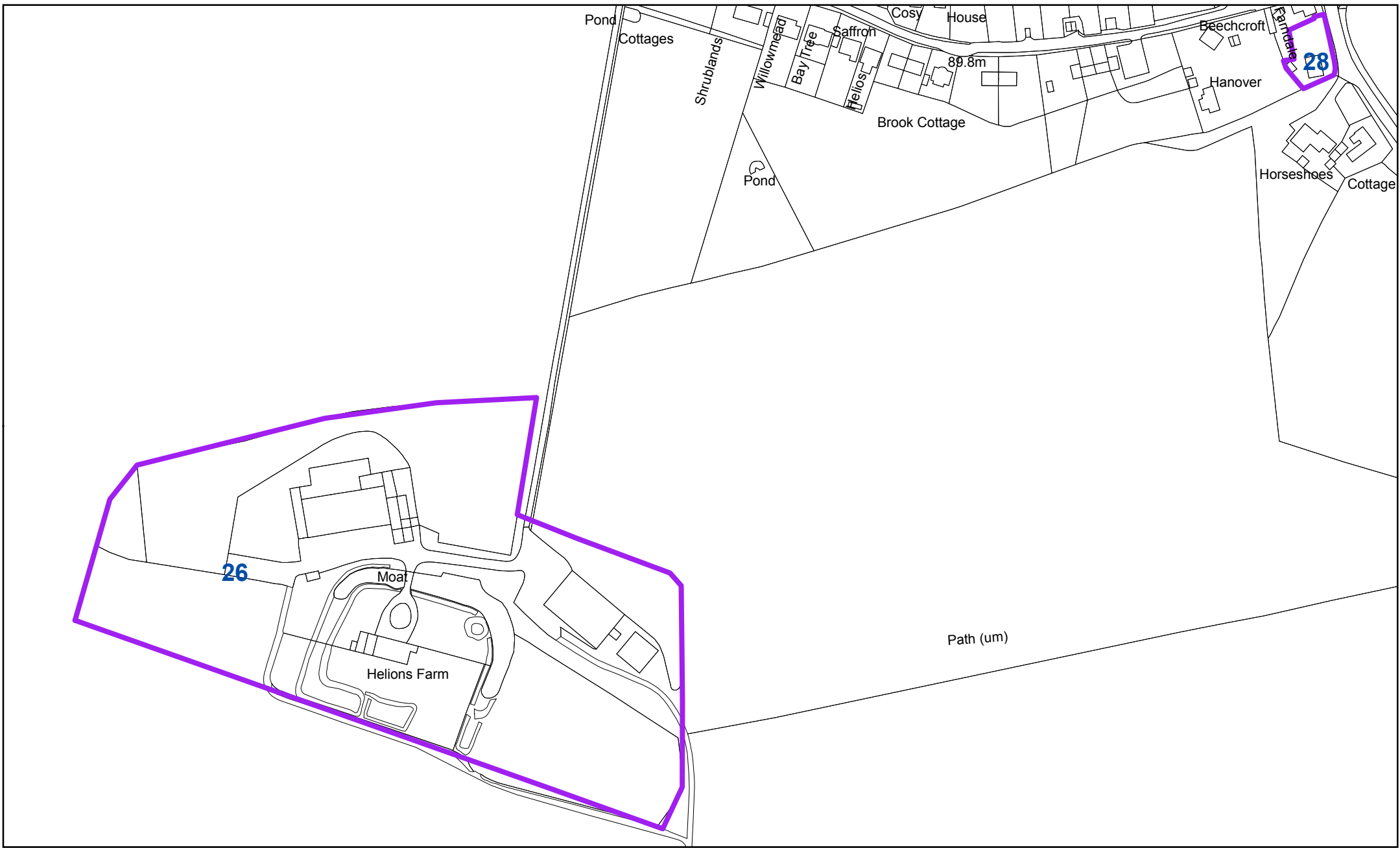

Helions Bumpstead:
 26 - Barn at Helions Farm, Sages End
 28 - Crossroads, Water Lane

"Reproduced from the Ordnance Survey mapping with the permission of the Controller of her Majesty's Stationery Office © Crown Copyright. Unauthorised reproduction infringes Crown Copyright and may lead to prosecutions or civil proceedings."
 Braintree District Council O/S Licence No. LA 100018490. 2011

Key

- Sites with planning permission
- Sites without planning permission

