

RESIDENTIAL LAND AVAILABILITY

DWELLING SITES AS AT:

31.3.11

According to revised PDL
definition as at June 2010:
Dwelling plots on

PARISH: BRAINTREE SOUTH

Map site ref. no.	Location of site	Planning application reference where relevant	Estimated dwelling sites without planning permission	Dwelling sites with planning permission			Total all dwelling sites with planning permission	Sum total all dwelling sites with or without planning permission	Previously developed land	Greenfield
				Total site capacity (including built)	Dwellings not started					
				With outline plg.perm.	With full plg.perm.	Dwellings under construction				
396	Land south of Mill Hill	3/99			30		30	30	0	30
396	Land south of Mill Hill	1397/04					0	0	0	0
396	Land south of Mill Hill	985/07			109		109	109	0	109
396	Land south of Mill Hill	1074/05					0	0	0	0
549	The Riverside, St Johns Avenue (market housing)	187/10					66	66	66	0
549	The Riverside, St Johns Avenue (housing association)	187/10			53	2	55	55	55	0
569	Rear of 73 Park Drive	1630/09		1	1		1	1	0	1
587	Rear of 46-56 Challis Lane	1445/06	2				0	2	2	0
655	Stephenson road garage court		3				0	3	3	0
656	Depot site adj 5 Challis Lane		3				0	3	3	0
657	Land between 59 and 61 Skitts Hill		5				0	5	5	0
Total			13	1	192	68	261	274	134	140

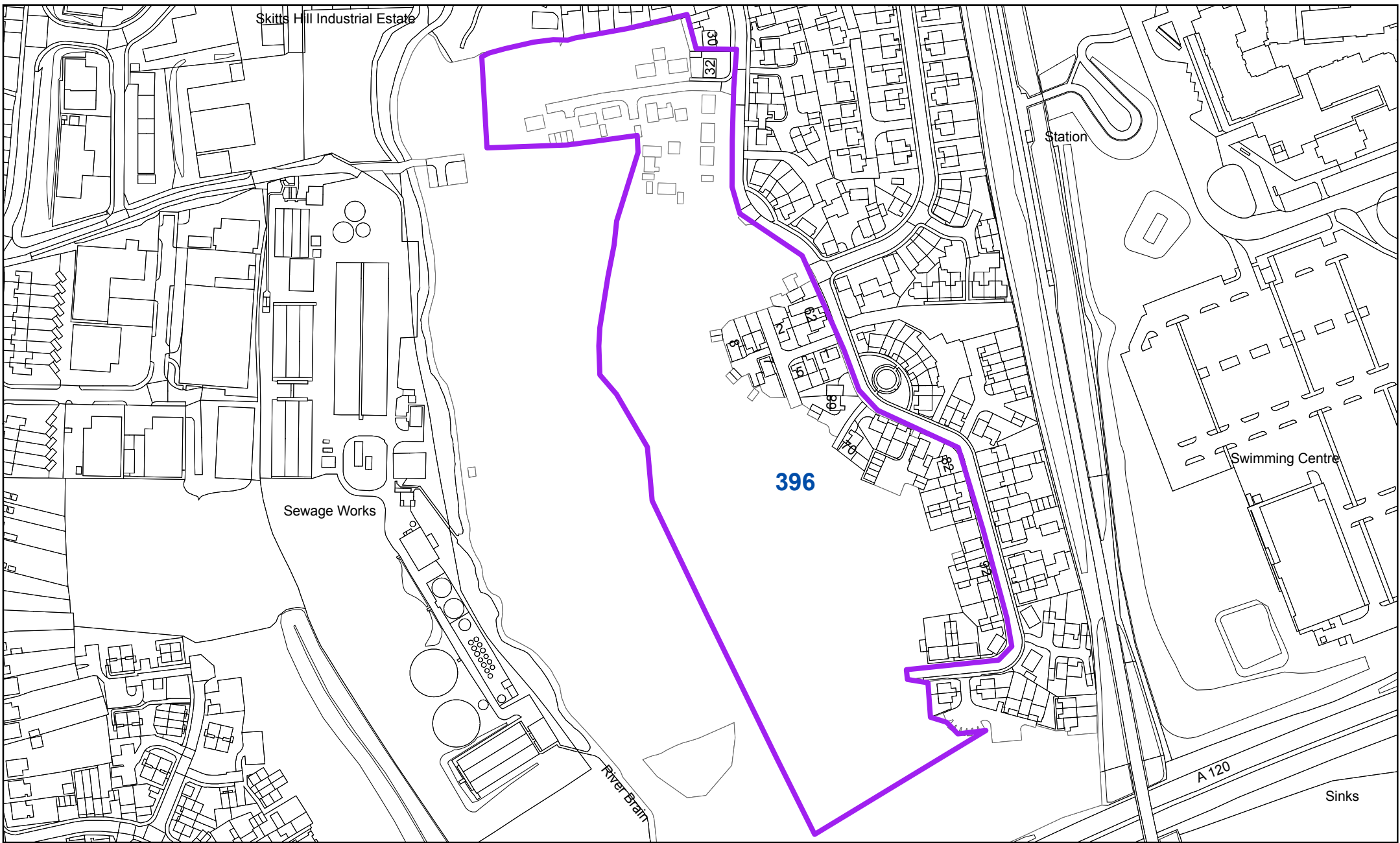

**Braintree South:
396 - Land south of Mill Hill**

"Reproduced from the Ordnance Survey mapping with the permission of the Controller of her Majesty's Stationery Office © Crown Copyright. Unauthorised reproduction infringes Crown Copyright and may lead to prosecutions or civil proceedings."
Braintree District Council O/S Licence No. LA 100018490. 2011

Key

- Sites with planning permission
- Sites without planning permission



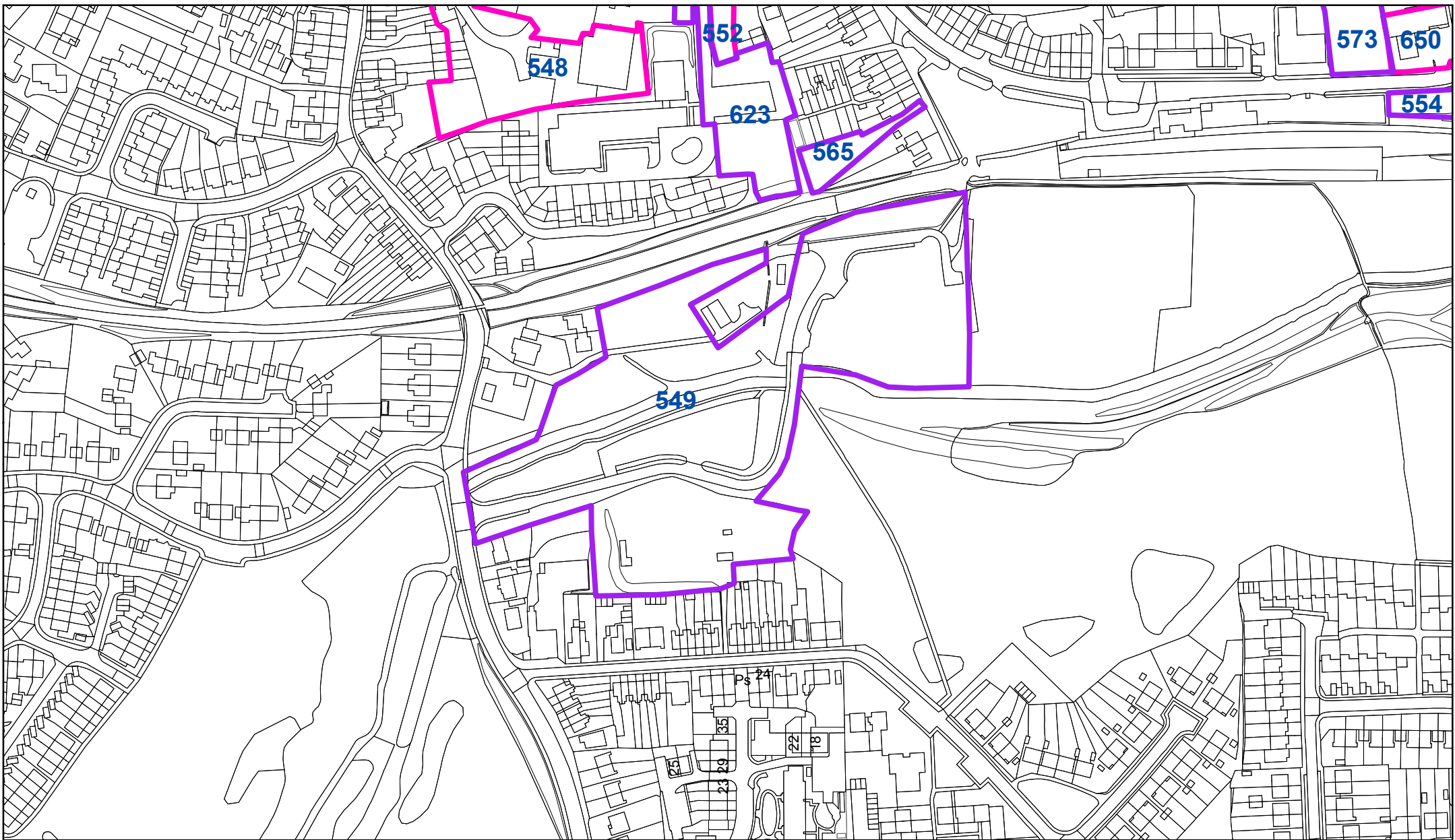

Braintree South:
549 - The Riverside, St Johns Avenue

"Reproduced from the Ordnance Survey mapping with the permission of the Controller of her Majesty's Stationery Office © Crown Copyright. Unauthorised reproduction infringes Crown Copyright and may lead to prosecutions or civil proceedings."
Braintree District Council O/S Licence No. LA 100018490. 2011

Key

- Sites with planning permission
- Sites without planning permission



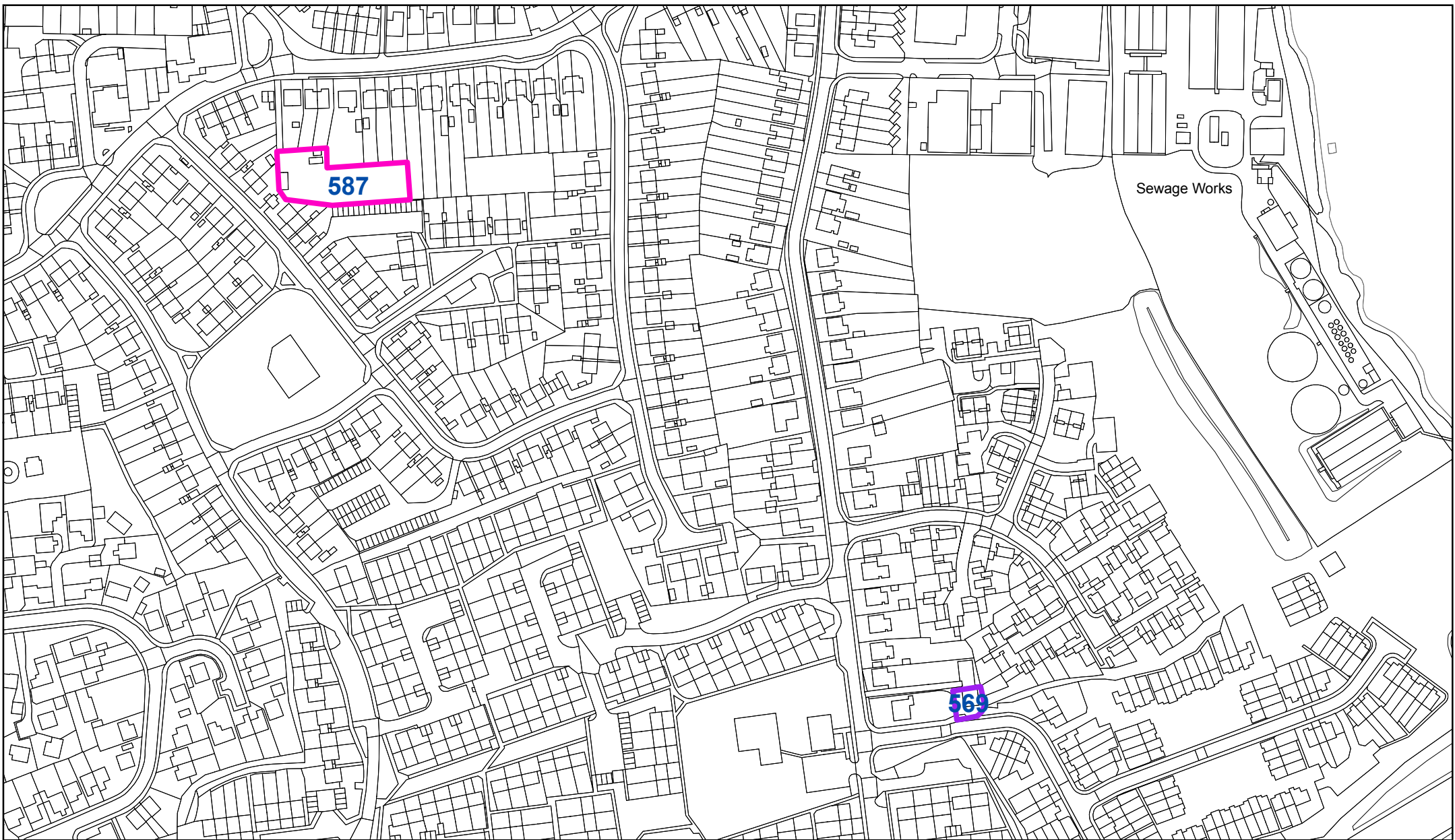

Braintree South:
569 - Rear of 73 Park Drive
587 - Rear of 46-56 Challis Lane

"Reproduced from the Ordnance Survey mapping with the permission of the Controller of her Majesty's Stationery Office © Crown Copyright. Unauthorised reproduction infringes Crown Copyright and may lead to prosecutions or civil proceedings."
Braintree District Council O/S Licence No. LA 100018490. 2011

Key

-  Sites with planning permission
-  Sites without planning permission



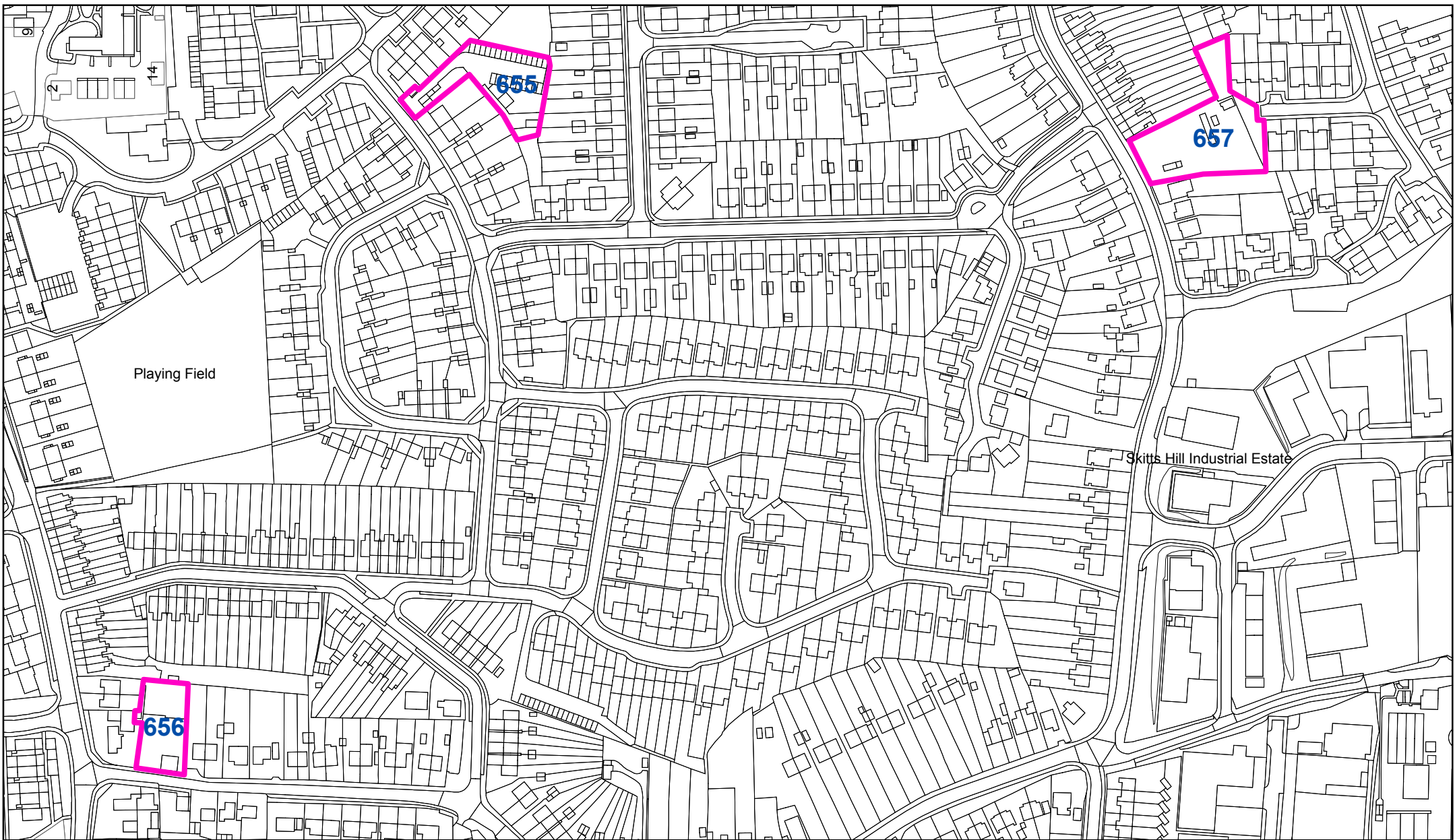

Braintree South:

- 655 - Stephenson Road garage court
- 656 - Depot site adj 5 Challis Lane
- 657 - Land between 59 and 61 Skitts Hill

"Reproduced from the Ordnance Survey mapping with the permission of the Controller of her Majesty's Stationery Office © Crown Copyright. Unauthorised reproduction infringes Crown Copyright and may lead to prosecutions or civil proceedings."
 Braintree District Council O/S Licence No. LA 100018490. 2011

Key

- Sites with planning permission
- Sites without planning permission

